

# STINSON

## CONTENTS

Univair is the Type Certificate holder for the Stinson 108 series. We have thousands of quality parts specifically for these airplanes. Many of our parts are made on the original tooling that was used when these great aircraft were first made.

Manuals .....	149	Fuel System.....	158
Brakes .....	149	Landing Gear • Chassis .....	158
Cockpit • Interior .....	150	Modification Kits.....	160
Control System.....	152	Propellers.....	161
Decals • Stencils .....	154	Tail Section.....	161
Electrical System.....	154	Windows • Windshields.....	162
Engine • Cowling • Exhaust .....	155	Wings.....	163
Frame.....	157	Engine Conversion Kits.....	166

**All parts listed are for the 1946, 1947 and 1948 models of the 108 series Stinson, unless otherwise specified. Many parts can be correctly identified by the nomenclature listed in this section. However, we suggest that you also have the Stinson parts manual (SPM) to assist you in selecting the correct parts.**

### Manuals

Description	Part #	Price
108 Series Parts Catalog.....	SPM	\$36.92
General Service Manual .....	SSM	\$48.76
Service Bulletins and Letters.....	SBL	\$34.08
Stinson Specifications, ADs and STCs.....	SSS	\$14.20
108 CAA Operating Limits .....	108CAA	\$8.52
108-1 CAA Approved Operating Limits.....	1CAA	\$11.89
108-2 CAA Approved Flight Manual .....	2CAA	\$8.52
108-3 CAA Approved Flight Manual .....	3CAA	\$8.52
108-1 Owner's Manual.....	1WM	\$19.41
108-2 Owner's Manual.....	2WM	\$19.41
108-3 Owner's Manual.....	3WM	\$19.41
108-1 Seaplane Operating Limits.....	1SP	\$11.89
108-2 Seaplane Flight Manual.....	2SP	\$8.52
108-3 Seaplane Flight Manual.....	3SP	\$8.52
108 Ski-Plane Supplement.....	SKS	\$2.39
108-1 Ski-Plane Supplement .....	1SKS	\$2.39
108-2/-3 Sensenich Propeller Supplement.....	SFMS	\$1.42
Appendix A Supplement (165hp Conversion) .....	SXA	\$2.39
Stinson Story of Aircraft Progress.....	SSY	\$27.46
Stinson Time/Speed/Distance Computer.....	SWC	\$14.90
Stinson Computer Instructions.....	SCI	\$8.37

### Brakes

Description	Part #	Price
Brake Cylinder Outlet Coil Assembly.....	108-5101303-0	\$456.61
Coil Brake Line Assembly .....	108-5101303-2	\$618.98
Brake Line Coil Assembly .....	108-5101303-4	\$292.25
Flexible Brake Hose.....	108-5101304-1	\$303.85
Parking Brake Control Support Assembly .....	108-5101305	\$99.94
Support.....	108-5101305-2	\$162.75
Parking Brake Control Bridle .....	108-5101310-6	\$139.42
Parking Brake Control Bridle .....	108-5101310-8	\$48.44
Bridle Link Assembly.....	108-5101312	\$44.23
Brake Line .....	108-5101313-2	\$48.02
Bracket.....	108-5101314	\$230.95
Brake Line (Cleveland) .....	108-5102017	\$88.98
Union .....	108-5102018-6	\$57.75
Master Cylinder .....	108-9010075	\$1,559.31

Ordering is easy at [www.univair.com](http://www.univair.com)



# Cockpit • Interior

Description	Part #	Price
Primer and Throttle Support Assembly, 1946.....	108-3021100	\$44.90
Primer and Throttle Support Assembly, 1947-78 .....	108-3022100	\$43.53
Top Instrument Panel Cover, 1946-48 .....	108-3031009-1	\$253.60
Trim Extrusion, 64" Long, 1947-48 .....	108-3031009-16	\$110.91
Control Panel Connector Plate, 1947-48.....	108-3032022-10	\$17.10
Door Trim Panel, Left, 1946 .....	108-3091004-2	\$129.01
Door Trim Panel, Right, 1946.....	108-3091004-3	\$129.01
Inspection Cabin Headlining Zipper, 1946-48		
Aft .....	108-3091028	\$15.60
Forward.....	108-3091029	\$12.78
Safety Belt Plate, 1947-48 .....	108-3091032	\$40.73
Plain End Safety Belt, 1946.....	108-3091037	\$99.71
Cabin Ventilator Inner Tube, 1946 .....	108-3091056	\$122.07
Cabin Ventilator Valve Seat Assembly, 1946 .....	108-3091059	\$125.79
Rear, Side and Back Panel, 1946 .....	108-3091072	\$716.90
Control Column Boot Clamp, 1946 .....	108-3091078	\$85.09
Control Column Boot Assembly, 1946 .....	108-3091079	\$40.65
Ventilator Cap, 1946-47 .....	108-3091095	\$112.42
Cabin Ventilator Valve Seat, 1947.....	108-3091096-0	\$188.13
Rear Cabin Ventilator Valve Seat, 1948.....	108-3091096-1	\$61.90
Cabin Ventilator Inner Tube, 1947 .....	108-3091097-6	\$78.41
Rear Cabin Ventilator Inner Tube, 1948 .....	108-3091097-8	\$134.21
Cabin Forward Side Panel, Right, 1947 .....	108-3092092-1	\$156.52
Cabin Forward Side Panel, Right, 1947 .....	108-3092092-3	\$139.48
Door Frame Scuff Plate, Left, 1946-48 .....	108-3092112-6	\$249.53
Door Frame Scuff Plate, Right .....	108-3092112-7	\$249.53
Door Frame Trim Retainer, Left, 1947-48 .....	108-3092113-6	\$138.45
Door Frame Trim Retainer, Right, 1947-48 .....	108-3092113-7	\$138.45
Control Column Cover, 1947-48.....	108-3092118	\$118.63
Forward Panel Retainer, Left, 1947 .....	108-3092119-0	\$45.92
Forward Panel Retainer, Right, 1947.....	108-3092119-1	\$45.92
Forward Panel Retainer, Left, 1948 .....	108-3092119-2	\$46.24
Forward Panel Retainer, Right, 1948.....	108-3092119-3	\$48.57
Rear Ventilator Cap, 1948.....	108-3092141-6	\$151.50
Rear Cabin Vent Scoop, Left, 1948 .....	108-3092145-6	\$120.64
Rear Cabin Vent Scoop, Right, 1948 .....	108-3092145-7	\$120.64
Upper Rear Side Panel, Left, 1947 .....	108-8992004	\$116.68
Upper Rear Side Panel, Right, 1947.....	108-8992004-1	\$116.68
Rear Panel Support Channel, 1947-48 .....	108-8992008	\$65.40
Cargo Retainer Assembly, 1947-48 .....	108-8992019	\$139.48
Rear Seat Bracket Cover, 1947 .....	108-8992025-6	\$66.89
Rear Seat Bracket Cover, 1948.....	108-8992025-8	\$66.89

## Air Temperature Gauge

This thermometer has both Centigrade and Fahrenheit dial graduations. It can be installed through Plexiglas® windshield or cowling on most aircraft or through the center strip in the windshield.



2716A .....\$82.28

## Knobs and Handles



471-060



108-3412029



A1021-A-15

Black Control Knob .....	471-060	\$3.70
Red Control Knob .....	108-6221502-20	\$7.33
Cabin Assist Handle, 1947-48 .....	108-3412029	\$55.20
Cabin Assist Handle Plate, 1947-48.....	108-3092115	\$9.92
Cabin Door Inside Handle, Left or Right, 1947-48.....	A1021-A-14	\$100.89
Cabin Door Outside Handle, Left, 1947 .....	A1021-A-15L	\$126.73
Cabin Door Outside Handle, Right, 1947 .....	A1021-A-15R	\$126.73
Cabin Door Outside Handle, Left, 1946 .....	A1021-A-9L	\$126.73

## Cabin Floor

Forward Cabin Floor Carpet, 1946 .....	108-3091044	\$102.44
Aft Cabin Floor Carpet, 1946 .....	108-3091045	\$128.04
Aft Cabin Floorboard, 1946 .....	108-3091052-2	\$139.48
Rear Aft Floorboard Assembly, 1948 .....	108-8992007-0	\$295.96
Rear Aft Floorboard Assembly, 1947 .....	108-8992007-2	\$862.46
Forward Rear Floor Assembly, 1948.....	108-8992007-30	\$142.03
Aft Cabin Floor Carpet, 1947 .....	108-3092045	\$141.58
Forward Cabin Floorboard, Left, 1946-48.....	108-3092052-28	\$330.32
Forward Cabin Floorboard, Right, 1946-48 .....	108-3092052-29	\$311.86
Intermediate Cabin Floorboard, Right, 1947-48.....	108-3092052-3	\$64.34
Intermediate Cabin Floorboard, Right, 1948 .....	108-3092052-30	\$52.41
Intermediate Cabin Floorboard, Left, 1947.....	108-3092052-4	\$81.38

## Glove Box

Glove Box Door Assembly, 1946.....	108-3031018	\$97.88
Glove Box Door Assembly, 1947-48.....	108-3032018	\$164.35
Glove Box Door Catch Spring, 1947-48.....	108-3032038	\$34.66
Glove Box, 1947-48.....	108-3092053	\$120.86
Glove Box Knob, Black.....	471-060	\$3.70

## Baggage Compartment

Baggage Compartment Curtain, 1947-48.....	108-3002261-0	\$246.00
Baggage Door Hinge, 1947-48.....	108-3002264	\$37.79
Baggage Compartment Floor Assembly, 1947 .....	108-3002266-2	\$534.84
Baggage Compartment Front Wall, 1947 .....	108-3002267-2	\$434.68
Baggage Door Hold Back Spring, 1947-48 .....	108-3002268	\$47.13
Baggage Door Hold Back Spring Spacer, 1947-48.....	108-3002270	\$4.75
Baggage Door Frame Fabric Retainer, 1947-48.....	108-3002273	\$95.60
Upper Angle Support, 1947-48.....	108-3002274	\$32.49
Lower Angle Support, 1947-48.....	108-3002275	\$42.47
Baggage Tie Down Strap, Buckle End, 1948 .....	108-3002281-6	\$17.68
Baggage Tie Down Strap, Plain End, 1948.....	108-3002281-8	\$17.67

## Oleo Strut Housing Cover

• Applicability: Stinson 108 Series

108-3091011 .....\$479.51



## Seats

Rear Seat Tube, 1946-48 .....	108-3091001-8 .....	<b>\$136.43</b>
Bottom Cushion, Left, 1946.....	108-3091017-32 .....	<b>\$294.65</b>
Bottom Cushion, Right, 1946.....	108-3091017-33 .....	<b>\$294.65</b>
Front Seat Back, Left, 1946.....	108-3091017-34 .....	<b>\$355.98</b>
Front Seat Back, Right, 1946.....	108-3091017-35 .....	<b>\$354.31</b>
Rear Seat Bottom Cushion, 1946.....	108-3091023 .....	<b>\$245.95</b>
Rear Seat Back Cushion, 1946.....	108-3091025 .....	<b>\$419.64</b>
Rear Seat Bottom Cushion, 1948.....	108-3092135 .....	<b>\$247.46</b>
Rear Front Seat Support Assembly, 1946-48.....	108-3092007 .....	<b>\$333.88</b>
Front Seat Bottom Cushion, Right, 1947 .....	108-3092017-33 .....	<b>\$307.37</b>
Rear Seat Back Cushion, Right, 1948.....	108-3092143-3 .....	<b>\$337.33</b>

## Placards

• Descriptions, images, and sizes of placards can be found on [www.univair.com](http://www.univair.com)

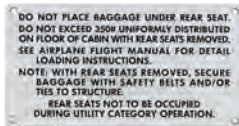

Operating Limitations Placard, 1946.....	108-8741001-6 .....	<b>\$26.66</b>
Baggage Placard, 1946 .....	108-8741001-8 .....	<b>\$21.64</b>
Tab Control Placard, 1946-47 .....	108-8742000 .....	<b>\$39.06</b>
Baggage Placard, 1947 .....	108-8742001-12 .....	<b>\$23.60</b>
Station Wagon Baggage Placard, 1947 .....	108-8742001-16 .....	<b>\$69.35</b>
Operating Limitations Placard, 1948.....	108-8742001-20 .....	<b>\$27.23</b>
Baggage Placard, 1948 .....	108-8742001-22 .....	<b>\$12.65</b>
Station Wagon Baggage Placard, 1948.....	108-8742001-24 .....	<b>\$28.50</b>
Cabin Baggage Placard, 1947-48.....	108-8742001-26 .....	<b>\$28.63</b>
Operating Limitations Placard, 1947.....	108-8742001-6 .....	<b>\$38.80</b>
Rudder and Elevator Trim Placard, 1948.....	108-8742200 .....	<b>\$78.16</b>

## 1946 Standard and Basic Blind Flight Instrument Panel

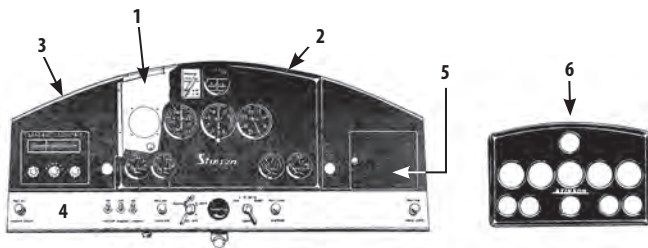

1) Flight Panel Assembly.....	108-3031021 .....	<b>\$254.02</b>
2) Indirect Instrument Panel Assembly.....	108-3031002 .....	<b>\$58.93</b>
3) Main Panel Assembly.....	108-3031003 .....	<b>\$444.86</b>
4) Control Panel Assembly .....	108-3031004 .....	<b>\$80.83</b>
5) Glove Box Door Assembly .....	108-3031018 .....	<b>\$97.88</b>
6) Basic Blind Flight Indirect Panel Assembly.....	108-8931005 .....	<b>\$325.25</b>

## 1947-48 Standard and Basic Blind Flight Instrument Panel

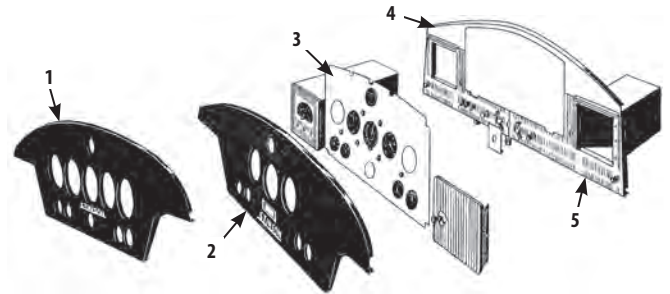

1) Basic Blind Flight Indirect Panel Assembly		
1947 .....	108-8932005-0* .....	<b>\$156.52</b>
1948 .....	108-8932005-1 .....	<b>\$156.52</b>
2) Indirect Instrument Panel Assembly		
1947 .....	108-3032002-0* .....	<b>\$173.31</b>
1948 .....	108-3032002-1* .....	<b>\$173.31</b>
3) Flight Panel Assembly, 1947-48.....	108-3032021-8 .....	<b>\$370.45</b>
4) Main Panel Assembly, 1947-48.....	108-3032003 .....	<b>\$321.03</b>
5) Control Panel Assembly, Right Half, 1947-48.....	108-3032022-8 .....	<b>\$348.27</b>

\* These parts are original Stinson inventory, and sold in an "AS IS" condition

## 1946-1948 Advanced Blind Flight Instrument Panel

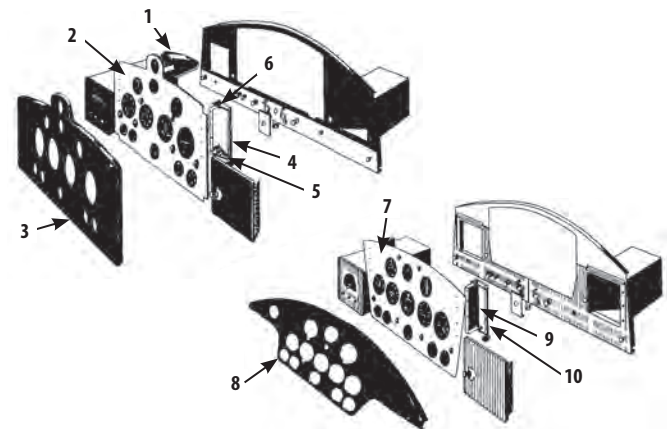

1) Direction Indicator Cover, 1946.....	108-8931006 .....	<b>\$104.39</b>
2) Direction Panel Assembly, 1946.....	108-8931003-2 .....	<b>\$112.72</b>
3) Indirect Panel Assembly, 1946.....	108-8931003-4* .....	<b>\$244.19</b>
4) Support Assembly, 1946.....	108-8931003-10 .....	<b>\$81.95</b>
5) Shock Mounts, 1946 .....	100PL-4 .....	<b>\$14.50</b>
6) Bracket Assembly, 1946 (8931003-14).....	108-8932019-0 .....	<b>\$88.46</b>
7) Direct Panel Assembly, 1947-1948 .....	108-8932021-1 .....	<b>\$298.59</b>
8) Indirect Panel Assembly, 1947-1948.....	108-8932022-0/-1 .....	<b>N/A</b>
9) Instrument Panel Bracket Assembly, 1947-48 .....	108-8932019-0 .....	<b>\$88.46</b>
10) Instrument Panel Bracket Assembly, 1947-48 .....	108-8932020 .....	<b>\$241.06</b>

\* These parts are original Stinson inventory, and sold in an "AS IS" condition  
N/A = Not available

### Full Gyro Instrument Panels • 1946-48

This shock-mounted floating panel is simple to install. Both kits consist of the following parts: one instrument mounting panel, one false panel, two supports, and two brackets.

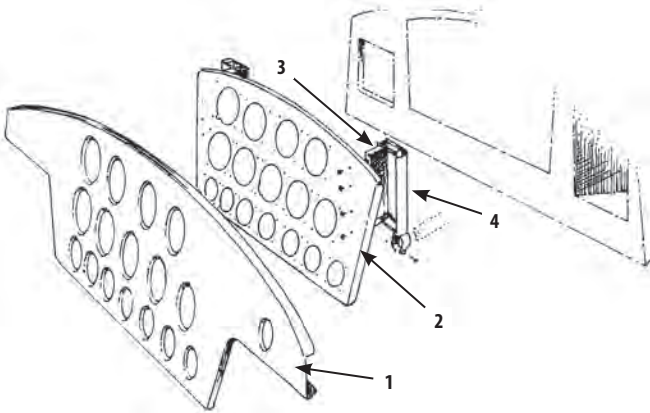

**This panel uses the old style 4 7/8" artificial horizon**

Full Gyro Instrument Panel Kit .....	108-8932007K .....	<b>\$1,587.69</b>
1) Indirect Panel Assembly.....	108-8932006-0 .....	<b>\$592.86</b>
2) Direct Panel Assembly .....	108-8932007-0 .....	<b>\$337.90</b>
3) Instrument Panel Bracket .....	108-8932019-0 .....	<b>\$88.46</b>
4) Instrument Panel Support .....	108-8932020 .....	<b>\$241.06</b>

**This panel uses the smaller 3 1/8" artificial horizon**

Full Gyro Instrument Panel Kit .....	108-8932007-1K .....	<b>\$1,587.69</b>
1) Indirect Panel Assembly.....	108-8932006-1 .....	<b>\$452.02</b>
2) Direct Panel Assembly .....	108-8932007-1 .....	<b>\$281.85</b>
3) Instrument Panel Bracket .....	108-8932019-0 .....	<b>\$88.46</b>
4) Instrument Panel Support .....	108-8932020 .....	<b>\$241.06</b>

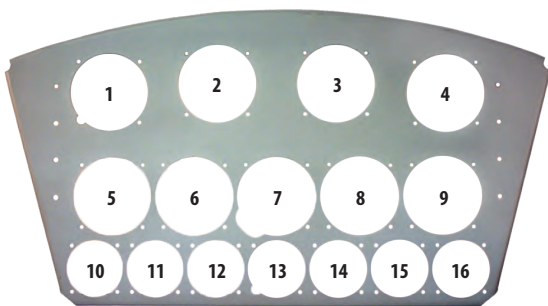

The panel above shows the locations of the following instruments:

**Top Row**

1) VOR Indicator, 2) Artificial Horizon, 3) Directional Gyro, 4) ADF Compass

**Middle Row • All 3 1/8 Inch Instruments**

5) Air Speed Indicator, 6) Turn and Bank, 7) Sensitive Altimeter, 8) Rate of Climb, 9) Tachometer

**Bottom Row • All 2 1/4 Inch Instruments**

10) Oil Pressure Gauge, 11) Oil Temperature Gauge, 12) Suction Gauge, 13) Clock, 14) Cylinder Head Temperature Gauge, 15) Fuel Quantity Gauge, 16) Ammeter

See our website for available instruments and gauges.

## Control System

<b>Description</b>	<b>Part #</b>	<b>Price</b>
Elevator Tab Control Casing Assembly, 1946-48 .....	108-2241602 .....	<b>\$192.97</b>
Elevator Tab Mechanism Housing, 1946-48.....	108-2241603 .....	<b>\$120.09</b>
Elevator Tab Control Shaft, 1946-48 .....	108-2241606 .....	<b>\$128.00</b>
Elevator Trim Tab Control Shaft, 1946-48 .....	108-2241608 .....	<b>\$514.68</b>
Elevator Trim Tab Mechanism Rod, 1946-48.....	108-2241610 .....	<b>\$226.62</b>
Vertical Stabilizer, 1946-47 .....	108-2311000 .....	<b>\$4,432.00</b>
Rudder Steering Arm, 1946-48 .....	108-2583 .....	<b>\$172.89</b>
Rudder Assembly, Includes Tab, 1948 .....	108-2602100 .....	<b>\$4,500.17</b>
Rudder Assembly, 1946-47 .....	108-2611000 .....	<b>\$3,712.29</b>
Tube Assembly, Left, 1948 .....	108-3041000-30 .....	<b>\$68.61</b>
Right.....	108-3041000-32 .....	<b>\$68.61</b>
Control Wheel Hub Casting, 1946.....	108-3041121 .....	<b>\$12.67</b>
Control Column Shaft Pulley, Left, 1946-48 .....	108-3041204-0 .....	<b>\$143.16</b>
Right.....	108-3041204-2 .....	<b>\$143.16</b>
Fairlead Pulley, 1946-48 .....	108-3041209 .....	<b>\$22.82</b>
Flap Handle Lever Adjustment Rack, 1946-48 .....	108-3041501 .....	<b>\$53.78</b>
Flap Control Handle Latch, 1946-48.....	108-3041502 .....	<b>\$12.53</b>
Flap Control Handle Release, 1946-48 .....	108-3041503 .....	<b>\$291.34</b>
Flap Pushrod Assembly, 1946-48 .....	108-3041504 .....	<b>\$307.25</b>
Flap Control Handle Tube, 1946-48 .....	108-3041506 .....	<b>\$388.11</b>
Elevator Tab Control Shaft Bushing, 1946-47 .....	108-3041603 .....	<b>\$8.22</b>
Control Wheel Shaft Assembly, 1947-48 .....	108-3042153 .....	<b>\$170.90</b>
Trim Control Pulley, 1947-48.....	108-3042424-6 .....	<b>\$150.04</b>
Trim Control Pulley, 1947-48.....	108-3042424-8 .....	<b>\$108.44</b>
Rudder Bungee Kit, 1946-47 .....	108-3042450 .....	<b>\$3,050.84</b>
Elevator/Rudder Trim Control Sleeve, 1947-48.....	108-3042457-6 .....	<b>\$145.95</b>
Elevator/Rudder Trim Control Shaft, 1947-48.....	108-3042458-6 .....	<b>\$54.23</b>
Elevator/Rudder Tab Control Support, 1948 .....	108-3042459-2 .....	<b>\$357.59</b>
Rudder Trim Spring, 1947.....	108-3042462-6 .....	<b>\$43.82</b>
Trim Control Pulley, 1947 .....	108-3042463-6 .....	<b>\$90.66</b>
Rudder Brake Spring, 1948 .....	108-3042627-6 .....	<b>\$18.01</b>
Rudder Bar Assembly, Right, 1948 .....	108-3942408 .....	<b>\$2,028.67</b>
Dual Brake Link Assembly, 1948 .....	108-3942410-2 .....	<b>\$102.91</b>
Escutcheon, 1946-48.....	108-8041000-1 .....	<b>\$30.79</b>
Flap Return Spring, 1946-48 .....	108-8441000 .....	<b>\$81.12</b>
Flap Handle Release Spring, 1946-48 .....	108-8441001 .....	<b>\$7.10</b>
Control Shaft Support Bushing, 1946-47 .....	108-8611000 .....	<b>\$26.00</b>
Bellcrank Bushing, 1947-48 .....	108-8612003 .....	<b>\$17.08</b>
Universal Joint, 1946-48 .....	12PF-744 .....	<b>\$514.80</b>

### Throttle and Control Cables



Friction Throttle, 1946-1948 .....	108-6222501-0 .....	<b>\$413.05</b>
Vernier Throttle .....	108-6222501-1 .....	<b>\$231.52</b>
Carburetor Heat Control, 44" Length, Locking, Black Knob (5101306, A700-BL-0440) ...	A700-10-0440 .....	<b>\$75.43</b>
Stinson Control, 44" Length.....	108-6221502 .....	<b>\$132.85</b>
Carburetor Mixture Control, 42" Length .....	108-6221502-1 .....	<b>\$214.92</b>
Cabin Heat Control, 1946, 62" Length .....	108-6221502-2 .....	<b>\$123.49</b>
Cabin Heat Control, 1947-1948, 58" Length.....	108-6221502-3 .....	<b>\$110.91</b>
Brake Control, 28" Length .....	108-6221502-4 .....	<b>\$145.46</b>

## Control Cables

- All cables are priced and sold individually

### Aileron

Aileron Idler Cable, 2 required	
Galvanized.....	108-1141206 ..... <b>\$149.90</b>
Stainless.....	108-1141206S ..... <b>\$199.71</b>
Aileron Control Cable, 2 required	
Galvanized.....	108-1141208 ..... <b>\$120.75</b>
Stainless.....	108-1141208S ..... <b>\$180.66</b>
Aileron Idle Cable (in frame), 1 required	
Galvanized.....	108-3041118 ..... <b>\$81.31</b>
Stainless.....	108-3041118S ..... <b>\$108.40</b>
Control Column Cable, Left Half, 1 required	
Galvanized.....	108-3041123-6 ..... <b>\$192.92</b>
Stainless.....	108-3041123-6S ..... <b>\$196.32</b>
Control Column Cable, Right Half, 1 required	
Galvanized.....	108-3041123-7 ..... <b>\$192.92</b>
Stainless.....	108-3041123-7S ..... <b>\$196.32</b>

### Elevator

"Up" Elevator Cable, 1 required	
Galvanized.....	108-3041305-10 ..... <b>\$149.44</b>
Stainless.....	108-3041305-10S ..... <b>\$161.84</b>
"Down" Elevator Cable, 1 required	
Galvanized.....	108-3041305-11 ..... <b>\$156.10</b>
Stainless.....	108-3041305-11S ..... <b>\$161.84</b>

### Elevator Trim

Elevator Tab, Cabin to Control Cable, S/N 1 to 2249, 1 required	
Galvanized.....	108-3041615-0 ..... <b>\$104.62</b>
Stainless.....	108-3041615-0S ..... <b>\$145.12</b>
Elevator Tab, Cabin to Control Cable, S/N 2250 and up, 1 required	
Galvanized.....	108-3041615-1 ..... <b>\$123.49</b>
Stainless.....	108-3041615-1S ..... <b>\$148.03</b>

### Flap

Flap Control Cable, 2 required	
Galvanized.....	108-1141506 ..... <b>\$124.86</b>
Stainless.....	108-1141506S ..... <b>\$140.61</b>
Upper Flap Control Cable (in frame), 1 required	
Galvanized.....	108-3041511 ..... <b>\$129.18</b>
Stainless.....	108-3041511S ..... <b>\$156.80</b>

### Rudder

Rudder Cable, 1946-1947, 2 required	
Galvanized.....	108-3041003-0 ..... <b>\$146.43</b>
Stainless.....	108-3041003-0S ..... <b>\$197.61</b>
Rudder Cable, 1948, 2 required	
Galvanized.....	108-3041003-2 ..... <b>\$202.18</b>
Stainless.....	108-3041003-2S ..... <b>\$183.42</b>

### Rudder Trim

Rudder Trim Cable, S/N 2250 to 3499*, 2 required	
Galvanized.....	108-3042620 ..... <b>\$109.41</b>
Stainless.....	108-3042620S ..... <b>\$120.45</b>

Rudder Trim Cable, S/N 2250 to 3499*, 1 required	
Galvanized.....	108-3042622 ..... <b>\$144.48</b>
Rudder Trim Cable, 108-3, S/N 3500 and up, 1 required	
Galvanized.....	108-3042426 ..... <b>\$179.27</b>
Stainless.....	108-3042426S ..... <b>\$186.20</b>

\* Used with rudder bungee system

## Stinson Control Surface Bearing

Control Surface Bearing.....	CS3906 ..... <b>\$38.74</b>
Felt Seal.....	108-8001001 ..... <b>\$2.71</b>



## Tachometer Cable

• 36 inch length	
Recording.....	TACH-36 ..... <b>\$161.70</b>
Non-Recording.....	TACH-36NR ..... <b>\$161.70</b>



## Rudder Control

Rudder Pedal	
Copilot, 1947.....	108-3042405 ..... <b>\$40.12</b>
Pilot, 1947.....	108-8542013-6 ..... <b>\$175.96</b>
Pilot and Copilot, 1948.....	108-8542013-6 ..... <b>\$175.96</b>
Copilot, 1946.....	108-3041405 ..... <b>\$27.89</b>
Rudder Control Drive Shaft, 1948.....	108-3042428 ..... <b>\$92.47</b>
Rudder Tab Mechanism Rod Assembly, 1948.....	108-3042429 ..... <b>\$188.13</b>
Copilot Rudder Pedal Return Spring, 1948.....	108-3042431-6 ..... <b>\$6.45</b>
Rudder Bar Assembly, Left, 1946.....	108-3041406 ..... <b>\$224.84</b>
Rudder Bar Assembly, Right, 1946.....	108-3041408 ..... <b>\$224.84</b>
Rudder Pedal Torque Tube Bearing, 1946-48.....	108-3041411 ..... <b>\$237.35</b>
Rudder Tab Control Pulley, 1948.....	108-3041612 ..... <b>\$44.90</b>
Rudder Bar Return Spring, 1946-48.....	108-3041002 ..... <b>\$29.90</b>
Rudder/Elevator Tab Control Spindle, 1947.....	108-3042452-6 ..... <b>\$152.94</b>
Rudder Trim Cable Clamp Fitting, 1947.....	108-3042619-6 ..... <b>\$15.49</b>
Rudder Trim Control Shaft Assembly, 1948.....	108-3042430 ..... <b>\$598.99</b>
Rudder Trim Cable Clamp, 1947.....	108-3042451-6 ..... <b>\$36.05</b>
Rudder Trim Frame Assembly, 1947.....	108-3042453 ..... <b>\$306.88</b>
Rudder Trim Control Knob, 1947-48.....	108-3042456-8 ..... <b>\$69.70</b>
Rudder Trim Control Arm Assembly, 1947	
Left.....	108-3042461-0 ..... <b>\$258.88</b>
Right.....	108-3042461-1 ..... <b>\$258.88</b>

## Dual Brake Kit

Available for Stinson 108 series. Provides brake actuation from both front seats (required item for student instruction). Simple installation; no welding. Complete kit with drawing. See our website for complete list of all parts and hardware included in this kit.



• Kit Weight: 11.10 lbs	
Dual Brake Kit.....	108-3942001 ..... <b>\$4,150.32</b>

**Elevator Control**

Elevator Bellcrank, 1946-48.....	108-3041303.....	<b>\$153.87</b>
Elevator Push-Pull Tube Assembly, 1946-48.....	108-3041304.....	<b>\$486.78</b>
Elevator Control Stop, 1946-48.....	108-3041306.....	<b>\$218.04</b>
Elevator Tab Front Control Pulley, 1946-1947.....	108-3041601.....	<b>\$44.90</b>
Elevator Tab Control Crank Arm Assembly		
1946-47, S/N 1 to 2249.....	108-3042610.....	<b>\$48.81</b>
1947-48, S/N 2250 and up.....	108-3042618-2.....	<b>\$515.51</b>
Elevator Control Arm Stop, 1946-48.....	108-3041602-8.....	<b>\$18.16</b>
Elevator Control Shaft, 1946-47, S/N 1 to 2249.....	108-3041604.....	<b>\$42.43</b>
Elevator Tab Control Shaft, 1946-48.....	108-3041606.....	<b>\$80.27</b>
Elevator Tab and Rudder Trim Control		
Support Assembly, 1947, S/N 2250 and up.....	108-3042459-0.....	<b>\$272.15</b>
Pulley Assembly, 1947-48, S/N 2250 and up.....	108-3042460-2.....	<b>\$1,032.42</b>
Elevator Tab Control		
Front Support Assembly, 1946-47, S/N 1 to 2249.....	108-3041608.....	<b>\$44.38</b>
Front Pulley Assembly, 1946-47, S/N 1 to 2249.....	108-3041609.....	<b>\$142.03</b>
Elevator Tab Control Rear Bushing, 1946-48.....	108-3041617.....	<b>\$27.29</b>

**Decals • Stencils**



For 108, S/N 119 to 742

"Voyager 150", Left Side, Mask.....	108-3091048-6.....	<b>\$75.55</b>
"Voyager 150", Right Side, Mask.....	108-3091048-7.....	<b>\$75.55</b>

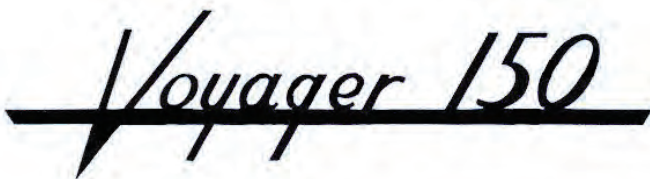

Stinson "Voyager 150"

Stencil.....	108-3091048-37.....	<b>\$19.33</b>
--------------	---------------------	----------------



For 108-1, S/N 743 to 2249

"Voyager 150", Left Side, Mask.....	108-3092048-6.....	<b>\$75.55</b>
"Voyager 150", Right Side, Mask.....	108-3092048-7.....	<b>\$75.55</b>



For 108-2 and 108-3, S/N 2250 and up

"Stinson Voyager" Stencil.....	108-3092126.....	<b>\$32.00</b>
--------------------------------	------------------	----------------



For 108-2 and 108-3, S/N 2250 and up

"Stinson Flying Station Wagon", Stencil.....	108-8992034.....	<b>\$62.03</b>
--	------------------	----------------



"Bow and Arrow" Tail Fin Stencils

Left Stencil.....	108-3091039-6.....	<b>\$46.67</b>
Right Stencil.....	108-3091039-7.....	<b>\$46.67</b>

**Electrical System**

Description	Part #	Price
Landing Light Lens Retainer, 1946-48.....	108-1111086.....	<b>\$29.25</b>
Landing Light Lens Retainer, Left, 1946-48.....	108-1111087.....	<b>\$24.71</b>
Landing Light Lens, 1946-48.....	108-1111091.....	<b>\$81.35</b>
Antenna Mast Assembly, 1946-47.....	108-2311014.....	<b>\$12.78</b>
Rudder Light Bracket, 1946-48.....	108-2661001.....	<b>\$80.58</b>
Radio Support Assembly, 1946.....	108-3031501.....	<b>\$11.38</b>
Radio Loudspeaker Baffle Board, 1946.....	108-3031503.....	<b>\$73.75</b>
Radio Loudspeaker Grille, 1946.....	108-3031504.....	<b>\$12.78</b>
Loop Antenna Spring, 1946-48.....	108-3031506-0.....	<b>\$2.82</b>
Radio Support Assembly, 1947-48.....	108-3032501.....	<b>\$135.97</b>
Loop Antenna Assembly, 1947.....	108-3032507.....	<b>\$34.10</b>
Mast Antenna Bracket, 1947.....	108-3032521.....	<b>\$14.79</b>
Mast Antenna Bracket, 1948.....	108-3032525.....	<b>\$4.18</b>
Battery Box Cover, 1946-47.....	108-3061001.....	<b>\$277.36</b>
Battery Box Assembly, 1946-47.....	108-3061002.....	<b>\$542.11</b>
Battery Tie Down Rod, 1946-47.....	108-3061004.....	<b>\$37.04</b>
Battery Ground Cable, 1946-47.....	108-3061008-10.....	<b>\$13.01</b>
Battery Ground Cable, 1948.....	108-3062012.....	<b>\$68.03</b>
Fuel Gauge Sending Unit, 1946-48.....	7740-313.....	<b>\$422.61</b>



**Bendix Ignition Switch**

- With "Start" position
- For all light planes

Switch.....	10-357200-1.....	<b>\$661.42</b>
Placard for switch.....	10-126676.....	<b>\$5.10</b>

**Single Pole Solenoid Battery Relay**

- Use as master solenoid on Stinson 108 series
- Normally open
- Supersedes part number 70-918

Battery Relay.....	70-111226-5.....	<b>\$35.80</b>
--------------------	------------------	----------------



## Concorde Batteries



- Applicability: Stinson 108, 108-1, 108-2, 108-3, 108-5
- Valve regulated sealed lead acid batteries

12 Volt, 29 Amp Hour ..... RG-35A ..... **\$468.00**

## Engine • Cowling • Exhaust

To insure the proper selection of parts, we suggest that you use your Stinson parts manual (SPM) with this catalog. Please include your aircraft model and serial number when ordering.

Description	Part #	Price
Magneto Noise Filter, 1946-48.....	A293	<b>\$190.14</b>
Aeromatic Baffle Kit, 1946-48.....	4086	<b>\$418.35</b>
Cowl Support Tube Clip, 1947-48.....	108-6022423	<b>\$47.87</b>
Generator Blast Tube, 1946-48.....	108-6201000-28	<b>\$34.27</b>
Engine Oil Drain Tube, 1947-48.....	108-6201011-6	<b>\$96.97</b>
Oil Drain Valve Block 'U' Bolt, 1947-48.....	108-6201012	<b>\$80.73</b>
Engine Oil Drain Valve Block, 1947-48.....	108-6201013	<b>\$98.54</b>
Duct, 7 inches, 1946-48.....	108-6202000-12	<b>\$35.73</b>
Valve to Strainer Tube Assembly, 1946-47.....	108-6221100-52	<b>\$87.89</b>
Side Cooling Baffle, Right, 1946-48.....	108-6221202	<b>\$143.26</b>
Side Cooling Baffle, Left, 1946-48.....	108-6221203	<b>\$170.96</b>
Rear Cooling Baffle Assembly, 1946-48.....	108-6221204	<b>\$672.08</b>
Front Cooling Baffle Assembly, Left, 1946.....	108-6221206-0	<b>\$252.48</b>
Front Cooling Baffle Assembly, Left, 1947.....	108-6221206-1	<b>\$203.63</b>
Magneto Cooling Tube, Left, 1946-48.....	108-6221213-16	<b>\$43.55</b>
Magneto Cooling Tube, Right.....	108-6221213-17	<b>\$43.55</b>
Front Cooling Baffle Assembly, Right, 1946-47.....	108-6221216	<b>\$109.14</b>
Front Center Cooling Baffle, 1946-47.....	108-6221217	<b>\$31.24</b>
Exhaust Tailpipe Support Clamp, Left, 1946.....	108-6221705-0	<b>\$68.83</b>
Exhaust Tailpipe Support Clamp, Right, 1946.....	108-6221705-1	<b>\$71.95</b>
Tailpipe Support Angle, Left, 1946-48.....	108-6221709-6	<b>\$15.43</b>
Tailpipe Support Angle, Right, 1946-48.....	108-6221709-7	<b>\$13.94</b>
Exhaust Tailpipe Support Strap, 1946-48.....	108-6221710	<b>\$108.60</b>
Carburetor Air Box Assembly, 1946-47.....	108-6221807	<b>\$714.45</b>
Flexible Hose Attaching Collar, 1946.....	108-6221812-6	<b>\$18.50</b>
Cabin Heat Deflector Spring, 1946.....	108-6221814	<b>\$20.17</b>
Air Induction Cuff Clamp, 1946-47.....	108-6221815	<b>\$25.35</b>
Cabin Heat Deflector, 1946.....	108-6221816	<b>\$12.78</b>
Carburetor Air Box Gasket, 1946-47.....	108-6221817	<b>\$15.94</b>
Tank to Valve Tube Assembly, Right, 1947-48.....	108-6222100-10	<b>\$335.37</b>
Valve to Strainer Tube Assembly, 1947-48.....	108-6222100-52	<b>\$237.86</b>
Tank to Valve Tube Assembly, Left, 1947-48.....	108-6222100-8	<b>\$422.55</b>
Shroud Attach Channel, 1946-48.....	108-6221704	<b>\$76.16</b>
Front Cooling Baffle, 1947-48.....	108-6222219-0	<b>\$456.46</b>
Tailpipe Exhaust Clamp, 1947-48.....	108-6222715	<b>\$97.33</b>
Carburetor Air Box Assembly, 1947-48.....	108-6222807	<b>\$1,726.22</b>
Air Induction Cuff Clamp, 1947-48.....	108-6222815	<b>\$35.31</b>
Carburetor Air Box Gasket, 1947-48.....	108-6222817	<b>\$11.09</b>

## Aluminum Nose Cowl

- Applicability: Stinson 108 through 108-3
- Grilles sold separately

Nose Cowl ..... 108-6021401-52..... **\$1,839.05**  
 Left Grille ..... 108-8541008-7..... **\$559.33**  
 Right Grille..... 108-8541008-6..... **\$455.13**



## Carburetor Heat Shroud

- Applicability: 1946-48 Stinson 108 Series with Franklin engine

108-6221210-2..... **\$514.09**



## Cabin Heat Shroud

- Applicability: Stinson 108-1, -2 and -3
- Fits serial numbers 744 and up

108-6222209 ..... **\$576.36**



## Exhaust System

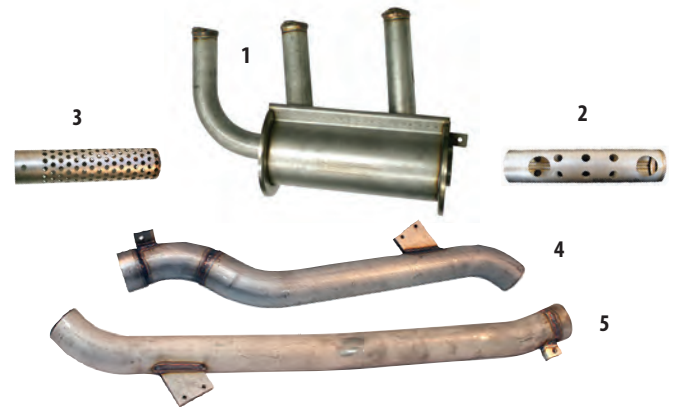

### Serial Numbers 1 to 3109

- 1) Muffler..... 108-6221702 ..... **\$1,323.79**
- 2) Perforated Tube..... 108-6221708 ..... **\$320.52**
- 4) Tailpipe, Left ..... 108-6221711-0 ..... **\$477.85**
- 5) Tailpipe, Right..... 108-6221711-1 ..... **\$525.62**

### Serial Numbers 3110 and up

- 1) Muffler..... 108-6222702 ..... **\$1,316.32**
- 3) Perforated Tube..... 108-6222708 ..... **\$320.52**
- 4) Tailpipe, Left ..... 108-6222711-0 ..... **\$437.00**
- 5) Tailpipe, Right..... 108-6222711-1 ..... **\$415.46**

## Bottom Cowl Assembly

- Does not include filter plate

108-6021401-70..... **\$3,906.19**



### Spinner Assemblies

- Complete spinner assemblies for Stinsons with wood or metal propellers

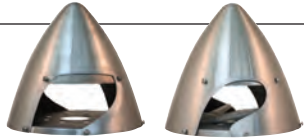

Wood Propeller Spinner Assembly .....	108-6921000-1 .....	<b>\$954.62</b>
Metal Propeller Spinner Assembly .....	108-6921000-2 .....	<b>\$1,059.55</b>
Wood Propeller Spinner Dome .....	108-6921000-6 .....	<b>\$614.16</b>
Metal Propeller Spinner Dome .....	108-6921000-30 .....	<b>\$607.01</b>
Wood Propeller Moisture Plate .....	U17577 .....	<b>\$133.16</b>
Propeller Bolts .....	U17662 .....	<b>\$36.62</b>
Wood and Metal Propeller Front Plate .....	108-6921000-20 .....	<b>\$253.52</b>
Wood and Metal Propeller Rear Plate .....	108-6921000-22 .....	<b>\$174.43</b>

**Note About Wooden Propeller Installation**

Due to the different hub contour of the various propellers approved on the 108 series aircraft, the FAA approved blueprint calls out "trim front bulkhead to clear propeller." This may be done with standard sheet metal shears and then the edge sanded smooth to prevent cracks in the bulkhead.

### Top Cowl Assembly

- Applicable to all 108 series Stinsons
- Includes right and left top cowls and center hinge assembly



Top Cowl Assembly .....	108-6021401-26 .....	<b>\$2,398.90</b>
Left Side Only .....	108-6021401-26L .....	<b>\$1,460.89</b>
Right Side Only .....	108-6021401-26R .....	<b>\$1,460.89</b>

### Engine Mount

- Applicability: All Franklin 150, 165 and 180hp engines



Engine Mount .....	108-6212000-1 .....	<b>\$2,888.52</b>
--------------------	---------------------	-------------------

### Engine Cowl Lever Assembly

Cowl Fastener Assembly 108-6021401-22 .....	<b>\$114.86</b>	
Cowl Fastener Pin 99836 .....	<b>\$3.45</b>	
Cowl Fastener Receptacle.....	130175-6P130 .....	<b>\$6.46</b>
Receptacle Cup.....	108-6021401-36 .....	<b>\$34.47</b>

### Air Induction Cuffs

For 108, 108-1, 108-2 150hp, S/N 1 to 2249.....	108-6221801 .....	<b>\$194.93</b>	
For 108-2, 108-3 165hp, S/N 2250 and up.....	108-6222801 .....	<b>\$194.93</b>	

### Carburetor Air Filter

- Applicability: Franklin 150-165hp engines
- Excludes the 6221805-8 bottom close out strip

Carburetor Air Filter.....	108-6221805 .....	<b>\$85.43</b>	
Close Out Strip .....	108-6221805-8 .....	<b>\$26.57</b>	

## Spinner Dome Installation Instructions

Used with McCauley 1A170 MET-L-PROP or Sensenich 74DR-0-XX on Stinson 108 series aircraft.

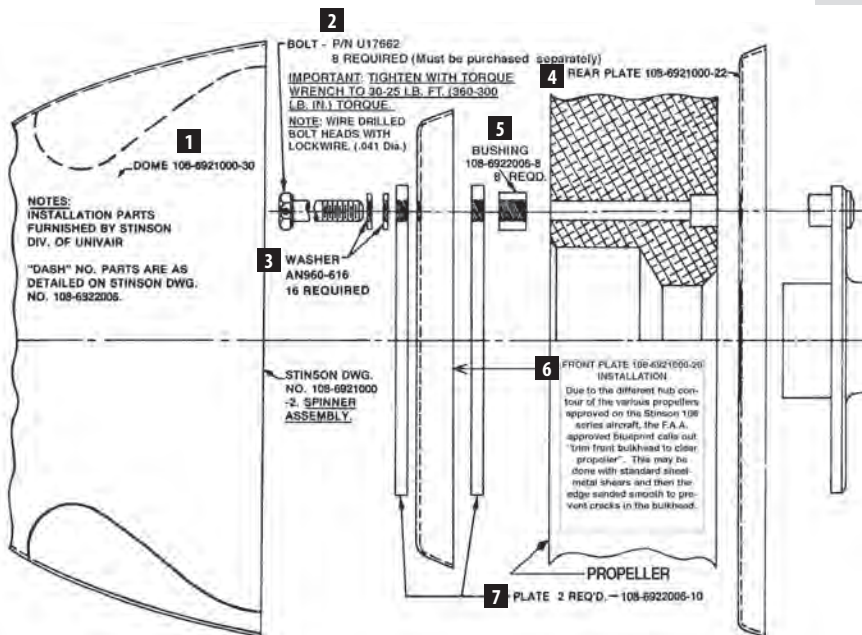

Name	Part Number	Price
1 Dome	108-6921000-30	<b>\$607.01</b>
2 Bolt	U17662	<b>\$36.62</b>
3 Washer	NAS1149F0663P	<b>\$0.11</b>
4 Rear Plate	108-6921000-22	<b>\$174.43</b>
5 Bushing	108-6922006-8	<b>\$15.53</b>
6 Front Plate	108-6921000-20	<b>\$253.52</b>
7 Spacer Plate	108-6922006-10	<b>\$94.96</b>



# Frame

Description	Part #	Price
Frame Match Rib Assembly, Left, 1946-48	108-3001201-0	\$556.92
Right	108-3001201-1	\$556.92
Former and Rib Assembly, Left, 1946-48	108-3001201-400	\$194.18
Right	108-3001201-401	\$194.18
Frame Shroud Panel, 1946-48	108-3001302	\$300.99
Frame Tunnel Cover Assembly, 1946-48	108-3001304	\$224.84
Cooling Tunnel Side Support, Left, 1946-48	108-3001306-0	\$112.72
Right	108-3001306-1	\$112.72
Firewall Panel, Stations 18.75 to 31.75, 1946-48	108-3001310-2	\$220.56
Landing Gear Opening Retainer, Left, 1946-48	108-3001434-6	\$92.08
Right	108-3001434-7	\$92.08
Frame Lower Longeron Retainer, Left, 1946-48	108-3001435-6	\$128.97
Right	108-3001435-7	\$128.97
Fuselage Former, Station 30.50 Fairing, 1946	108-3001437-0	\$127.90
Fuselage Former, Station 30.50 Fairing, 1947	108-3001437-1	\$114.73
Horizontal Stabilizer Fairing Plate, Left, 1946-47	108-3001445-0	\$54.91
Right	108-3001445-1	\$54.91
Fuselage Firewall, 1947	108-3002002-6	\$971.81
Fuselage Former, Station 30.50 Fairing, 1948	108-3002446-6	\$49.42
Frame Rear Compression Tube, 1946-47	108-3311003	\$115.26
Landing Gear Front Fitting, Left, 1946-48	108-3311007-0	\$509.41
Right	108-3311007-1	\$509.41
Landing Gear Rear Fitting, Left, 1946-48	108-3311016-0	\$566.31
Right	108-3311016-1	\$566.31
Fuselage Rear Compression Tube, 1948	108-3312003	\$224.25
Fuselage Assembly, 1946-47	108-3411000-3	\$27,797.19
Trim Control Tube, 1946-47	108-3411000-74	\$32.02
Cabin Step, Left, 1946-48	108-3411047-0	\$346.06
Right	108-3411047-1	\$346.06
Trim Control Bracket, 1946-47	108-3411060	\$42.36
Cabin Floor Support, 1946-48	108-8191000	\$47.92

## Cabin Doors and Windows

Door Latch Strike Plate, 1946-48	108-3001204-14	\$19.18
Upper Cabin Door Hinge, 1946-48	108-3001210	\$140.84
Front Window Strip, Left, 1946	108-3001211-114	\$78.82
Right	108-3001211-115	\$80.78
Aft Window Strip, Left, 1946	108-3001211-116	\$80.78
Right	108-3001211-117	\$104.77
Cabin Door Assembly, Left, 1946	108-3001211-2	\$1,352.60
Right	108-3001211-3	\$1,352.60
Cabin Door Assembly, Left, 1947	108-3001211-4	\$1,352.60
Right	108-3001211-5	\$1,352.60
Cabin Door Window Channel, 1946-47	108-3001211-60	\$36.92
Windshield Top Wood Strip, 1946-48	108-3001213	\$251.19
Cabin Door Window Lock Knob, 1946-47	108-3001214	\$4.79
Windshield Center Post, 1946-48	108-3001218	\$223.17
Windshield Center Post Retainer, 1946-48	108-3001220	\$26.57
Windshield Upper Retainer, 1946-48	108-3001221	\$26.57
Windshield Side Retainer, Left, 1946-48	108-3001222-6	\$48.30
Right	108-3001222-7	\$48.30

Cabin Window Retainer, Left, 1946-47	108-3001223-6	\$56.12
Right	108-3001223-7	\$70.84
Cabin Window Vertical Retainer, Left, 1946-47	108-3001224-6	\$12.06
Right	108-3001224-7	\$12.06
Cabin Door, Left, 1947	108-3002211-0	\$1,352.58
Right	108-3002211-1	\$1,352.58
Cabin Door, Left, 1948	108-3002211-2	\$1,352.58
Right	108-3002211-3	\$1,352.58
Station Wagon Cabin Door, Left, 1948	108-3002211-4	\$747.96
Right	108-3002211-5	\$747.96
Front Window Strip, 1946-48	108-3002211-18	\$152.76
Aft Window Strip, 1946-48	108-3002211-20	\$54.34
Cabin Door Window Striker, 1947	108-3002257	\$9.01
Cabin Door Window Striker Plate, 1948	108-3002277-6	\$15.83
Cabin Window Latch Spring, 1948	108-3002278-6	\$13.94
Cabin Door Window Lock Knob, 1948	108-3002279-6	\$46.68
Cabin Door Window Lock Knob, 1948	108-3002279-8	\$46.68
Cabin Door Window Trim Plate, 1948	108-3002280-6	\$9.20
Cabin Door Window Channels		
24.25", 1946-47	108-9000000-6	\$55.00
14.5", 1946-47	108-9000000-7	\$34.80
21.75", 1947-48	108-9000000-8	\$35.73
11.5", 1947-48	108-9000000-9	\$35.96

## Stinson Rear "D" Window Frame

• Applicability: Stinson 108-3

Left	108-3002240-2	\$708.61
Right	108-3002240-3	\$708.61



## Fuselage Bows

Fuselage Bow, Station 202.10, 1946-48	108-3001422	\$65.48
Fuselage Bow, Station 177.0, 1946-48	108-3001423	\$82.54
Fuselage Bow, Station 155.00, 1946-48	108-3001424	\$206.72
Fuselage Bow, Station 126.00, 1946-48	108-3001425	\$174.92
Fuselage Bow, Station 100.00, 1946-48	108-3001426	\$199.28
Fuselage Bow, Station 61.600, 1946-48	108-3001427	\$135.41
Fuselage Bow, Station 164.00, 1946-48	108-3001428	\$103.84
Fuselage Bow, Station 140.00, 1946-48	108-3001429-0	\$104.09
Fuselage Bow, Station 140.00, 1948	108-3001429-2	\$106.68
Fuselage Bow, Station 115.50, 1946-48	108-3001430	\$214.95
Fuselage Bow, Station 90.50, 1946-48	108-3001431	\$207.00
Fuselage Bow, Station 18.75, 1946-48	108-3001433	\$110.58
Fuselage Bow, Station 74.25 Fairing, 1946-48	108-3001436	\$147.79
Fuselage Bow, Station 40.50 Fairing, 1946-48	108-3001438	\$71.99
Fuselage Bow, Station 31.75 Fairing, 1946-48	108-3001442	\$174.81

## Frame to Landing Gear Fillets

Left	108-3001003-12	\$627.95
Right	108-3001003-13	\$627.95



Shop Online: [www.univair.com](http://www.univair.com)

### Round Inspection Plates

- Material: Aluminum
- Outside diameter: 4.75 inches
- Domed plate
- U12761-002 has additional rivets on the strap to help hold it in place

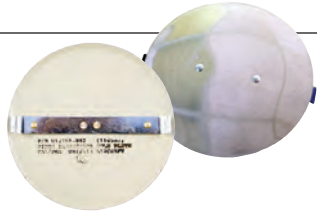

Original Piper Style Plate, With Additional Rivets ..... U12761-002 ..... **\$49.20**  
 Generic Version ..... 483-10 ..... **\$2.25**

### Stringer Blank

- Sold in 8 foot lengths only
- Oversize fee applies when shipping this item



8 Foot Blank ..... 108-3001432 ..... **\$56.29**

## Fuel System

Description	Part #	Price
Fuel Strainer Gasket, 1946-48 .....	2212A .....	<b>\$5.20</b>
Fuel Tank Cap, 1946-47 .....	108-1121111 .....	<b>\$197.79</b>
Fuel Cap Gasket, 1946-48 .....	108-1121112 .....	<b>\$2.43</b>
Fuel Tank Outlet Strainer, 1946-48 .....	108-1121118 .....	<b>\$52.89</b>
Fuel Tank Strap Head, 1946-48 .....	108-1121120 .....	<b>\$55.69</b>
Fuel Sender Gasket, 1946-48 .....	108-1121126 .....	<b>\$3.79</b>
Fuel Tank Outlet Strainer, 1947-48 .....	108-1122118 .....	<b>\$207.48</b>
Fuel Tank Cap, 1948 .....	108-1122131 .....	<b>\$121.05</b>
Fuel Tank, Right, 1948 .....	108-1122132-1 .....	<b>\$2,034.94</b>
Fuel Tank Vent Gasket, 1948 .....	108-1122134 .....	<b>\$10.77</b>
Fuel Valve Shaft, 1946 .....	108-3021103-0 .....	<b>\$42.79</b>
Fuel Valve Shaft, 1947 .....	108-3021103-1 .....	<b>\$44.90</b>
Gas Line Trim Cover, 1947-48 .....	108-3092111 .....	<b>\$176.84</b>
Tank to Valve Tube, 3/8 Inch, Left, 1946-47 .....	108-6221100-8 .....	<b>\$106.68</b>
Right .....	108-6221100-10 .....	<b>\$106.68</b>
Primer to Tee Line, 1946 .....	108-6221100-14 .....	<b>\$67.50</b>
Tee to Spray Tube, 1946-47 .....	108-6221100-16 .....	<b>\$83.01</b>
Strainer to Primer Tube, 1946 .....	108-6221100-44 .....	<b>\$83.54</b>
Valve to Strainer Tube, 1946-47 .....	108-6221100-52 .....	<b>\$87.89</b>
Fuel System Hose, 1946-47 .....	108-6221101 .....	<b>\$279.29</b>
Fuel Valve Shaft, 1947 .....	108-6221106 .....	<b>\$160.49</b>
Tee to Spray Tube, 1947-48 .....	108-6222100-28 .....	<b>\$41.38</b>
Primer Tube, 1947-48 .....	108-6222100-32 .....	<b>\$73.24</b>
Tank to Valve Tube, Left, 1947-48 .....	108-6222100-8 .....	<b>\$422.55</b>
Fuel Valve Shaft, 1947-48 .....	108-6222106 .....	<b>\$221.18</b>
Fuel Tank Strap Bolt, 1946-48 .....	108-8311000 .....	<b>\$42.49</b>
Strainer to Carburetor Hose, 1947-48 .....	U-108-6222101-1A .....	<b>\$292.55</b>

Toll Free Sales: 1-888-433-5433



### Fuel System Selector Valves

- Replaces original style valves
- Applications: left, right (not both), or off
- Not approved for higher horsepower engines
- See our website for complete list of all parts included in each kit



For 150hp aircraft with 3/8" fuel lines (44725) ..... 108-9010076-38 ..... **\$579.32**  
 For 165hp aircraft with 1/2" fuel lines (44745) ..... 108-9010076-12 ..... **\$579.32**

### Fuel Gauge and Sender

- Direct replacements for original gauge and sender



Gauge ..... 3090-033 ..... **\$249.29**  
 Sender ..... 7740-313 ..... **\$422.61**

## Landing Gear • Chassis

Description	Part #	Price
Landing Gear Fillet Assembly, Left, 1946-48 .....	108-3001003-12 .....	<b>\$627.95</b>
Right .....	108-3001003-13 .....	<b>\$627.95</b>
Oleo Housing Cap, 1946-48 .....	108-3091005 .....	<b>\$37.42</b>
Landing Gear Brake Shield, 1946 .....	108-5101007 .....	<b>\$9.92</b>
Landing Gear Brake Shield, 1946-48 .....	108-5101008 .....	<b>\$15.79</b>
Shock Strut Spring, 1946-48 .....	108-5181001 .....	<b>\$182.88</b>
Shock Strut Packing Retainer, 1946-48 .....	108-5181007 .....	<b>\$231.03</b>
Shock Strut Pin, 1946-48 .....	108-5181008 .....	<b>\$18.69</b>
Shock Strut Plunger, 1947-48 .....	108-5182006 .....	<b>\$1,033.96</b>
Piston Ring Set, 1947-48 .....	108-5182006-12-3 .....	<b>\$251.09</b>

### Parking Brake Valve Assembly



- Applicability: Stinson 108 Series
- Also for Piper PA-18 through PA-22

Parking Brake Valve Assemblies  
 U4500A-1 ..... **\$473.98**  
 U4500A-2 ..... **\$478.49**

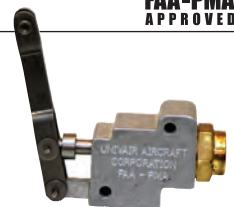

### Aircraft Ski Springs



- Atlee Dodge parts
- Applicability: Aeronca, Champion, Luscombe, Maule, Piper J-3 thru PA-22, Stinson, Taylorcraft
- Improves ski rigging tension in cold weather
- Use with tubular landing gear
- STC SA4624NM



Gold Color ..... 2127 ..... **\$230.00**  
 Silver Color ..... 2097 ..... **\$230.00**

### Tailwheel and Spring Assembly

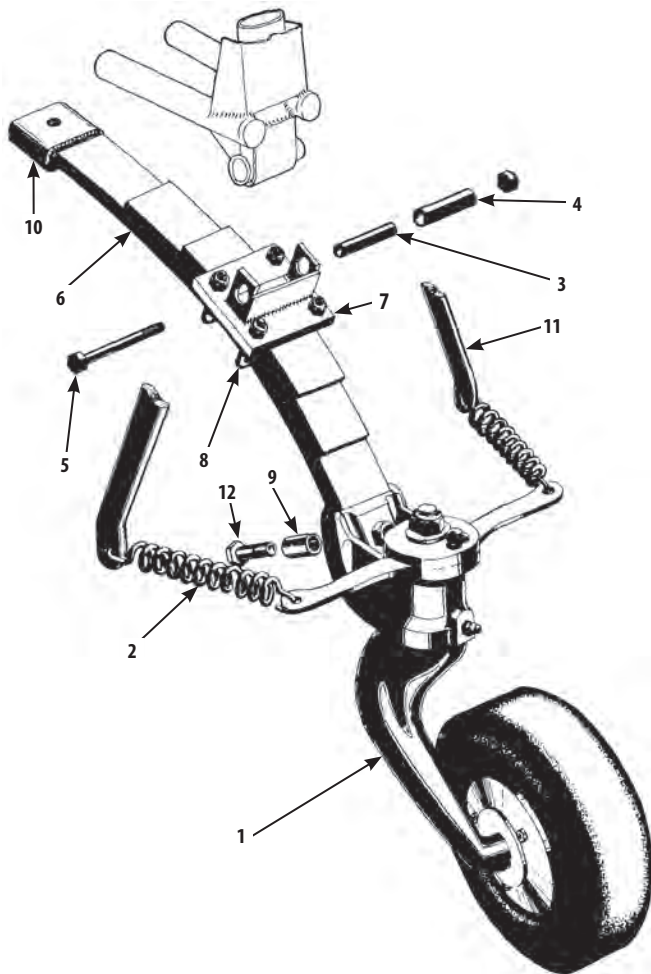

Figure/Description	Part #	Price
1) Wheel Assembly, Tail, 1946-48	45-2000	N/A
Bolt, 1946-48	AN8-14A	N/A
Washer (AN960-816), 1946-48	NAS1149F0863P	\$0.10
Nut (AN365-820), 1946-48	MS21044N8	\$0.88
2) Spring, Tailwheel Steering, 1946-48	U2134A-000	\$18.20
3) Bushing, 1946-48	108-5311000-10	\$51.86
4) Bushing, 1946-48	108-5311000-12	\$50.91
6) Tailwheel Spring Assembly, 1946-48	108-5311002-2	\$352.76
5) Bolt, 1946-48	AN5-25	\$1.22
Nut, 1946-48	AN310-5	\$2.00
Cotter Pin, 1946-48	AN380-2-2	\$0.04
Screw, 1946-48	MS35207-267	\$0.18
Washer, 1946-48	NAS1149F0363P	\$0.08
Nut, 1946-48	MS21083N3	\$0.22
Nut, 1946-48	MS21044N4	\$0.30
7) Tailwheel Spring Fitting, 1946-48	108-5311003-2	\$347.78
8) 'U' Bolt, 1946-48	108-5311005	\$58.13
9) Bushing, 1946-48	108-5311004	\$21.36
10) Tailwheel Spring Cushion, 1946-48	108-5311000-6	\$18.48
11) Steering Fork	108-2583	\$172.89
12) Bolt	AN8-14	\$6.30

### Landing Gear Assembly

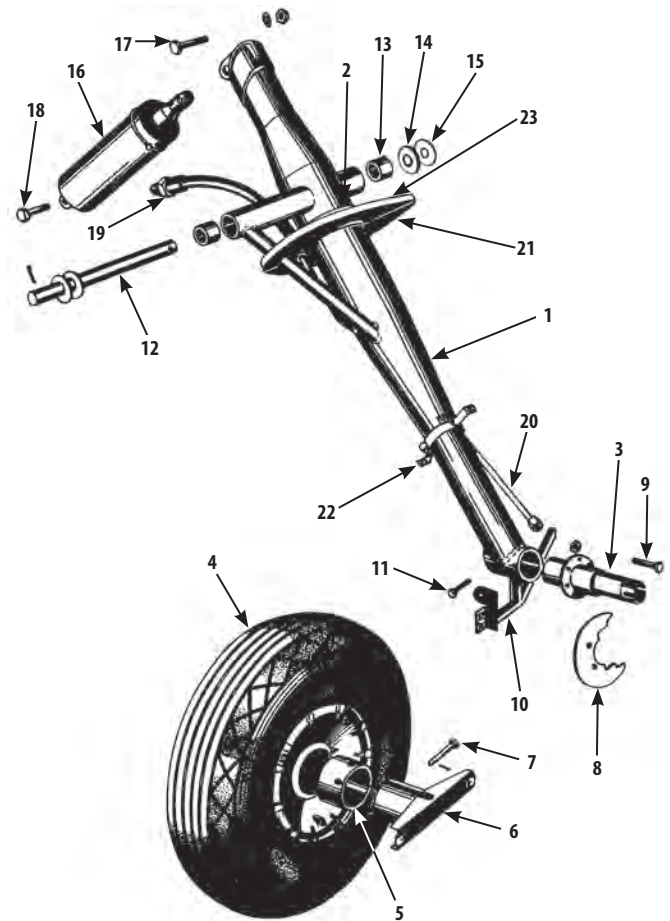

Figure/Description	Part #	Price
1) Landing Gear Beam (Includes Axle, Item 3), S/N 1 to 4124		
Left	108-5111000-0	\$2,952.09
Right	108-5111000-1	\$2,952.09
2) Upper Landing Gear Strut Clamp, 1946-48	108-5101103	\$61.18
3) Landing Gear Axle, S/N 1 to 4124	108-5611001	\$968.21
4) Tire, 7.00-6, 4-ply Heavy-Duty, 1946-48	108-5101000-14	N/A
Tube, 7.00-6, 1946-48	108-5101000-16	N/A
5) Goodyear Axle Nut, 1946-48	108-5111006	\$84.23
Cleveland Axle Nut, S/N 4435 to 447648	108-5112006-6	\$54.50
6) Wheel Pant Outer Bracket, 1946-48	108-5101104	\$178.92
7) Clevis Pin (AN394-57), 1946-48	MS20392-3C57	\$3.16
Cotter Pin, 1946-48	AN380-2-2	\$0.04
8) Shield, Landing Gear Wheel Brake,		
1946, S/N 1 to 81, 83 to 111	108-5101007	\$9.92
1946-48, S/N 82, 112 and up	108-5101008	\$15.79
9) Bolt, 1946-48	AN4-10A	\$0.26
10) Wheel Pant Inner Bracket, 1946-48		
Left	108-5101105-0	\$209.92
Right	108-5101105-1	\$221.99
11) Bolt, 1946-47	AN6-24A	\$1.20
Washer, 1946-47	NAS1149F0632P	\$0.06
Nut, 1946-47	MS21044N6	\$0.58
12) Pin, Landing Gear Hinge, 1946-48	108-5111005	\$278.88
13) Bushing, Landing Gear Hinge Pin, 1946-48	108-5111003	\$60.78
14) Washer (AN960-1216), 1946-48	NAS1149F1290P	\$0.38

Order online at [www.univair.com](http://www.univair.com)

15) Washer (AN960-1216L), 1946-48.....	NAS1149F1232P .....	<b>\$0.18</b>
16) Landing Gear Shock Strut, 1946-48.....	108-5181000 .....	<b>\$1,955.47</b>
17) Bolt, 1946-48 .....	AN6-14 .....	<b>\$1.44</b>
Washer, 1946-48 .....	NAS1149F0663P .....	<b>\$0.11</b>
Nut, 1946-48.....	AN310-6 .....	<b>\$2.58</b>
Cotter Pin (AN380-3-4), 1946-48 .....	MS24665-285 .....	<b>\$0.04</b>
18) Bolt, 1946-48 .....	AN6-21 .....	<b>\$1.85</b>
19) Flexible Brake Hose, 1946-48 (N/A on S/N 4435 to 4476).....	108-5101304-1 .....	<b>\$303.85</b>
20) Cleveland Brake Line, 1948 .....	108-5102017 .....	<b>\$88.98</b>
Goodyear Brake Line, 1946-48 .....	108-5101000-18 .....	<b>\$139.87</b>
21) Landing Strut Fairing Bulkhead, 1946-48 Left.....	108-5101102-8 .....	<b>\$54.25</b>
Right .....	108-5101102-9 .....	<b>\$54.25</b>
22) Lower Landing Gear Fairing Clamp, 1946-48.....	108-5101107 .....	<b>\$125.45</b>
23) Landing Strut Fairing Bulkhead, 1946-48 Left.....	108-5101102-6 .....	<b>\$85.87</b>
Right .....	108-5101102-7 .....	<b>\$85.87</b>

**Cleveland Conversion Kit**

Replace your original Goodyear wheels and brakes. This kit is approved by Type Certificate and is easy to install, requiring no modification to existing beam and axle assembly.

- Tire size: 7.00-6
- Will fit late model 108-3 with early axle nut and different plumbing



Cleveland Wheels & Brakes Kit.....199-08700 .... **\$4,648.34**

**Landing Gear Fairing**

Left Fairing  
108-5101100-10 ..... **\$411.46**



Right Fairing  
108-5101100-15 ..... **\$399.67**



**Bushwheel 3200 Tailwheel**

The 3200 series is a lightweight 8 inch tailwheel assembly designed to provide positive steering control far beyond rudder travel, and to release easily and automatically to full swivel when aircraft is turned around. The swivel mechanism is sealed to keep out water, sand and mud. Grease fittings are provided for lubrication. Precision components provide years of trouble-free service under severe operating conditions. Pneumatic assembly.



Pneumatic Assembly 3200 Tailwheel..... ABI-3200 .... **\$1,862.00**



For Specialty Tires, see the **Tires • Wheels • Brakes** section beginning on page 271

**Stinson's Golden Age, Volumes 1 and 2**

Two volumes about the history of the Stinson 108 series airplane (the Voyager), although the Stinson 105, Stinson 10 and 10A, as well as the Stinson L-5, are also covered in great detail. It begins in **Stinson's Golden Age, Volume 1**, with the three-place 105 in 1938 and concludes in **Stinson's Golden Age, Volume 2**, with the sale of the last Stinson 108-3 from Willow Run in 1950. The books include production figures, the disposal of surplus military aircraft, the all-Piper Apache and the chronicle of two Stinson dealers, all included to give the reader a better sense of the Golden Age of Aviation.



Stinson's Golden Age, Volume 1 ..... SGA-1 ..... **\$27.25**  
Stinson's Golden Age, Volume 2 ..... SGA-2 ..... **\$26.95**

**Modification Kits**

**Rudder Pulley Modification Kit**

- Complies with SB 266 (Piper Bulletin 114)

Modification Kit .....750-189 ..... **\$469.88**

**Float Fitting Kit**

- Complete with blueprint installation instructions
- Welding is required



108-3901001 ..... **\$1,437.40**

**Stinson Jettison Door Kit**

- Required for aircraft certified in the utility category
- Includes all parts and installation instructions

For S/N 1 to 3929 ..... 108-3992046.... **\$1,060.26**  
For S/N 3930 and up .....108-3992046-1..... **\$861.51**



**Rudder Bungee Kit**

Kit is required when 165hp or larger engine is installed in 108 or 108-1 Stinson. Some welding is required.

108-3042450 ..... **\$3,050.84**



Buy Stinson parts on [www.univair.com](http://www.univair.com)

We Accept:

# Propellers

Univair furnishes a bolt kit with each propeller purchase. Bolt kits can also be purchased separately from our website.

Propeller descriptions below show basic aircraft/engine model applicability. Check manufacturer's websites for exact applicability before purchasing, or contact our sales staff at 1-888-433-5433 and we can research it for you.

Please note that we do not stock all of the propellers listed. Non-stocked propellers require 2-3 months for delivery.

## McCauley Aluminum Fixed Pitch Propellers

Stinson 10, HW-75, Continental C-85.....	CM7144	.....	<b>\$5,679.19</b>
Stinson 10, HW-75, Continental C-85.....	CM7146	.....	<b>\$5,679.19</b>
Stinson 108 Series, Franklin 6A4.....	DM7654	.....	<b>\$5,726.21</b>
Stinson 108 Series, Franklin 6A4.....	SFC7654	.....	<b>\$5,345.60</b>
Stinson 108 Series, Franklin 6A4.....	DM7649	.....	<b>\$5,345.60</b>
Stinson 108 Series, Franklin 6A4.....	SFC7652	.....	<b>\$5,726.21</b>

## Sensenich Aluminum Propellers

Stinson 108 Series, Franklin 6A4.....	74DR-0-56	.....	<b>\$5,876.50</b>
---------------------------------------	-----------	-------	-------------------

## Sensenich Wood Propellers

Stinson 10, 105, HW-75, Continental A-75, A-80.....	W70DK-40	.....	<b>\$3,550.00</b>
Stinson 10, 105, HW-75, Continental A-75, A-80.....	W70DK-42	.....	<b>\$3,550.00</b>
Stinson 108 Series, Franklin 6A4.....	W76JR-53	.....	<b>\$5,195.00</b>

# Tail Section

Description	Part #	Price
Inboard Horizontal Stabilizer Rib, Left.....	108-2111001-6	..... <b>\$140.04</b>
Right.....	108-2111001-7	..... <b>\$140.04</b>
Inboard Stabilizer Half Rib, 1946-47 .....	108-2111005-6	..... <b>\$11.61</b>
Outboard Stabilizer Half Rib, 1946-47.....	108-2111005-8	..... <b>\$11.61</b>
Inboard Horizontal Stabilizer Half Rib, 1946-47 .....	108-2111006-6	..... <b>\$26.72</b>
Outboard Horizontal Stabilizer Half Rib, 1946-47 ..	108-2111006-8	..... <b>\$26.72</b>
Inboard Horizontal Stabilizer Half Rib, 1946-47 .....	108-2111007-6	..... <b>\$16.51</b>
Outboard Horizontal Stabilizer Half Rib, 1946-47 ..	108-2111007-8	..... <b>\$16.51</b>
Horizontal Stabilizer Rib, Station 52.69, 1946-48.....	108-2111008	..... <b>\$77.58</b>
Horizontal Stabilizer Outboard Fitting, 1946-48 .....	108-2111011	..... <b>\$191.79</b>
Outboard Stabilizer Skin, Right, 1948 .....	108-2111020-12	..... <b>\$257.03</b>
Inboard Stabilizer Skin, Left, 1948 .....	108-2111020-8	..... <b>\$257.03</b>
Stabilizer Rib, Station 28.00, 1948 .....	108-2111025	..... <b>\$88.46</b>
Stabilizer Rib, Station, Station 35.00, 1948.....	108-2111026	..... <b>\$99.96</b>
Stabilizer Rib, Station 42.50, 1948 .....	108-2111027	..... <b>\$91.76</b>
Elevator Tab Stud, 1946-48 .....	108-2201005	..... <b>\$59.04</b>
Elevator Outboard Rib, 1946-48, Left.....	108-2201007-22	..... <b>\$114.96</b>
Right.....	108-2201007-23	..... <b>\$131.01</b>
Elevator Tip Rib, 1946-48 .....	108-2201007-24	..... <b>\$142.01</b>
Vertical Stabilizer Spar, 1946-47 .....	108-2311000-10	..... <b>\$101.87</b>

Vertical Stabilizer Tip Assembly, 1946-47.....	108-2311000-407	.....	<b>\$64.93</b>
Vertical Stabilizer Rib, Station 63.35, 1946-47 .....	108-2311001	.....	<b>\$18.76</b>
Vertical Stabilizer Half Rib, Station 55.35, 1946-47			
Left.....	108-2311002-6	.....	<b>\$28.71</b>
Right.....	108-2311002-8	.....	<b>\$28.71</b>
Vertical Stabilizer Half Rib, Station 47.35, 1946-47			
Left.....	108-2311003-6	.....	<b>\$28.71</b>
Right.....	108-2311003-8	.....	<b>\$28.71</b>
Vertical Stabilizer Spar, 1946-47 .....	108-2311008	.....	<b>\$11.11</b>
Vertical Stabilizer Upper Hinge Bracket, 1946-47 .....	108-2311011	.....	<b>\$12.88</b>
Vertical Stabilizer Fairlead, 1948.....	108-2311015	.....	<b>\$16.30</b>
Fabric Side Strip, 1948.....	108-2312020-8	.....	<b>\$14.14</b>
Vertical Stabilizer Rib, 1948 .....	108-2312050-12	.....	<b>\$140.59</b>
Vertical Stabilizer Rib, 1948 .....	108-2312050-14	.....	<b>\$83.92</b>
Vertical Stabilizer Fairing, 1948.....	108-2312050-18	.....	<b>\$90.56</b>
Vertical Stabilizer Angle, 1948, Left .....	108-2312050-22	.....	<b>\$36.43</b>
Right.....	108-2312050-23	.....	<b>\$36.43</b>
Fin Fairing Seal, 1948.....	108-2312050-32	.....	<b>\$78.02</b>
Vertical Stabilizer Skin, 1948, Left.....	108-2312050-34	.....	<b>\$751.31</b>
Right.....	108-2312050-35	.....	<b>\$751.31</b>
Vertical Stabilizer Stiffener, 1948, Left .....	108-2312050-42	.....	<b>\$87.95</b>
Right.....	108-2312050-43	.....	<b>\$87.95</b>
Vertical Stabilizer Angle, 1948 .....	108-2312050-56	.....	<b>\$24.12</b>
Vertical Stabilizer Gusset, 1948.....	108-2312050-58	.....	<b>\$35.28</b>
Vertical Stabilizer Rib, 1948 .....	108-2312050-6	.....	<b>\$104.71</b>
Vertical Stabilizer Rib, 1948 .....	108-2312050-8	.....	<b>\$52.20</b>
Bracket Assembly, 1948 .....	108-2312051	.....	<b>\$121.68</b>
Fairing Angle, 1948.....	108-2602100-5	.....	<b>\$22.80</b>
Fairing Angle, 1948.....	108-2602100-6	.....	<b>\$30.07</b>
Fairing Angle, 1948, Left .....	108-2602100-81	.....	<b>\$16.21</b>
Right.....	108-2602100-91	.....	<b>\$21.04</b>
Rudder Spar, 1946-47 .....	108-2611000-10	.....	<b>\$163.54</b>
Rudder Skin, 1946-47, Left .....	108-2611000-6U	.....	<b>\$310.10</b>
Right.....	108-2611000-7U	.....	<b>\$310.10</b>
Upper Fairing Angle, 1946-47, Left.....	108-2611000-AL	.....	<b>\$17.00</b>
Right.....	108-2611000-AR	.....	<b>\$17.00</b>
Middle Fairing Angle, Left or Right, 1946-47 .....	108-2611000-B	.....	<b>\$17.00</b>
Lower Fairing Angle, Left or Right, 1946-47 .....	108-2611000-C	.....	<b>\$18.05</b>
Upper Rudder Fitting Assembly, 1946-48 .....	108-2611002	.....	<b>\$78.15</b>
Lower Rudder Fitting Assembly, 1946-48 .....	108-2611003	.....	<b>\$182.04</b>
Auxiliary Rudder Spar, 1946-47 .....	108-2611005	.....	<b>\$19.33</b>
Rudder Tip Rib, 1946-47.....	108-2611006	.....	<b>\$37.57</b>
Lower Rudder Rib, 1946-47 .....	108-2611007	.....	<b>\$18.20</b>
Rudder Horn Assembly, 1946-47 .....	108-2611008-0	.....	<b>\$215.62</b>

## Horizontal Stabilizer



Horizontal Stabilizer Assembly, 1946-1948.....	108-2111020	.....	<b>\$9,055.95</b>
Center Hinge Fitting, 1946-1947.....	108-2111012	.....	<b>\$191.79</b>
Outboard Left Skin, 1948 .....	108-2111020-6	.....	<b>\$257.03</b>
Inboard Right Skin, 1948 .....	108-2111020-14	.....	<b>\$257.03</b>
Fairing Plate Assembly, Left, 1946-1947 .....	108-3001445-0	.....	<b>\$54.91</b>
Right.....	108-3001445-1	.....	<b>\$54.91</b>

**Rudders**

These rudders and skin kits DO NOT have the original Stinson dimple corrugation; they use the Piper-Stinson designed "V" type corrugation.

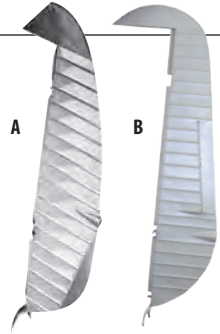

**Rudders**

- A) For 108, 108-1, 108-2  
108-2611000 ..... **\$3,712.29**
- B) For 108-3 (Includes Tab)  
108-2602100 ..... **\$4,500.17**

**Rudder Skin Kit**

- For 108, 108-1, 108-2 ..... 108-2611000-500 ..... **\$910.52**
- For 108-3 ..... 108-2602100-500 ..... **\$1,505.45**

**Rudder Bungee Kit**

Bungee Kit is required when 165hp engine or larger engine is installed in 108 or 108-1 Stinson. Some welding required.

- Complete Bungee Kit ..... 108-3042450 ..... **\$3,050.84**

**Additional Rudder Parts**

- Steering Arm, 1946-48 ..... 108-2583 ..... **\$172.89**
- Top Skin, 1948, Left ..... 108-2602100-8 ..... **\$254.51**
- Right ..... 108-2602100-9 ..... **\$254.51**
- Spar, 1948 (2602100-18) ..... 108-12905-4 ..... **\$159.83**
- Trim Tab, 1948 (2602100-64) ..... 108-12905-12 ..... **\$371.92**
- Light Housing, 1948, Left (2602100-68) ..... 108-12905-11 ..... **\$94.36**
- Right (2602100-69) ..... 108-12905-11 ..... **\$94.36**
- Trim Tab Spring, 1948 ..... 108-2602101-6 ..... **\$17.38**
- Top Skin, 1946-1947, Left ..... 108-2611000-8 ..... **\$40.96**
- Right ..... 108-2611000-9 ..... **\$40.96**
- Horn, with Bearing, 1948 ..... 108-2611008-2 ..... **\$223.90**

**Elevators**

These elevators DO NOT have the original Stinson dimple corrugation; they use the Piper-Stinson designed "V" type corrugation.

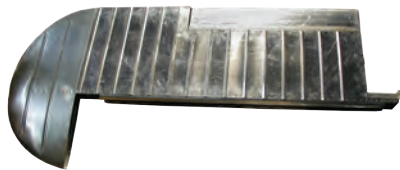

- Left (with Trim Tab), 1946-48 ..... 108-2201007-0 ..... **\$5,712.62**
- Right, 1946-48 ..... 108-2201007-1 ..... **\$5,712.62**

**Additional Elevator Parts**

- Trim Tab Assembly, 1946-47 ..... 108-2201001-0 ..... **\$378.84**
- Elevator Horn, 1946-48 ..... 108-2201006 ..... **\$120.83**
- Tab Mechanism Cover Assembly, 1946-48 ..... 108-2201012 ..... **\$26.13**
- Rudder Trim Casing Assembly, 1946-48 ..... 108-2241602 ..... **\$192.97**
- Rudder Tab Mechanism Housing, 1946-48 ..... 108-2241603 ..... **\$120.09**
- Tab Control Shaft Assembly, 1946-48 ..... 108-2241606 ..... **\$128.00**
- Trim Tab Control Shaft, 1946-48 ..... 108-2241608 ..... **\$514.68**
- Trim Tab Mechanism Rod, 1946-48 ..... 108-2241610 ..... **\$226.62**

**Vertical Stabilizer**

- Vertical Stabilizer Assembly, 1946-47 ..... 108-2311000 ..... **\$4,432.00**
- Lower Hinge Bracket, 1946-48 ..... 108-2311013 ..... **\$12.42**
- Fabric Strip, 1946-48 ..... 108-2311016 ..... **\$24.99**
- Fabric Trim Strip, S/N 2125 to 3500 ..... 108-2311017 ..... **\$27.89**
- Leading Edge Fabric Band, 1948 ..... 108-2312018-6 ..... **\$18.50**
- Side Trim Band, Left, 1948 (108-2312019-7) ..... 108-2312019-6 ..... **\$72.03**
- Outboard Fabric Side Strip, Left, 1948 ..... 108-2312020-6 ..... **\$14.45**
- Inboard Fabric Side Strip, Left, 1948 (2312020-8) ..... 108-2312020-6 ..... **\$14.45**
- Rear Spar, 1948 ..... 108-2312050-16 ..... **\$230.72**
- Front Spar, 1948 ..... 108-2312050-40 ..... **\$388.78**
- Dorsal Skin, 1948, Left ..... 108-2312050-52 ..... **\$213.97**
- Right ..... 108-2312050-53 ..... **\$128.29**
- Center Hinge Fitting, 1946-47 ..... 108-2611012 ..... **\$190.13**

**Vertical Stabilizer Skin**

- Upper vertical stabilizer skin stamping for 108-3 (original style)
- Left ..... 108-2312050-20 ..... **\$887.62**
- Right ..... 108-2312050-21 ..... **\$887.62**

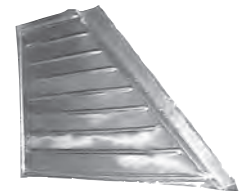

**Windows • Windshields**

Prices below are for clear windows and windshields only. See our website for prices and availability of Solar Gray and Green tinted versions. Delivery time is 10 to 12 weeks for non-stock items.

**Stinson L-5**

- Windshield Half, Left ..... 76-31073-0 ..... **\$210.13**
- Right ..... 76-31073-1 ..... **\$210.13**
- Windshield, 1-piece ..... 76-31073-2 ..... **\$353.43**
- Rear Window, Left ..... 76-31126-0 ..... **\$164.09**
- Rear Window, Right ..... 76-31126-1 ..... **\$192.31**

**Stinson 108, 108-1, 108-2 and 108-3**

- Windshield Half, Left ..... 108-3002208-6 ..... **\$271.76**
- Windshield Half, Right ..... 108-3002208-7 ..... **\$271.76**
- Rear Window, Left or Right  
(S/N 1 to 3499) ..... 108-3001212 ..... **\$53.46**  
(S/N 3500 and up) ..... 108-3002212 ..... **\$53.46**
- Forward Window Assembly, Left Door  
(S/N 1 to 1989) ..... 108-3001211-54 ..... **\$232.58**  
(S/N 1990 to 3499) ..... 108-3002211-26 ..... **\$223.78**  
(S/N 3500 and up) ..... 108-3002211-90 ..... **\$389.80**
- Forward Window Assembly, Right Door  
(S/N 1 to 1989) ..... 108-3001211-55 ..... **\$231.86**  
(S/N 1990 to 3499) ..... 108-3002211-27 ..... **\$249.58**  
(S/N 3500 and up) ..... 108-3002211-91 ..... **\$400.53**
- Rear Window Assembly, Left Door  
(S/N 1 to 1989) ..... 108-3001211-56 ..... **\$246.97**  
(S/N 1990 and up) ..... 108-3002211-28 ..... **\$194.61**

Visit our website to browse our full line of Stinson parts and supplies.  
[www.univair.com](http://www.univair.com)

Rear Window Assembly, Right Door		
(S/N 1 to 1989).....	108-3001211-57 .....	<b>\$159.71</b>
(S/N 1990 and up).....	108-3002211-29 .....	<b>\$237.55</b>

## Wings

Description	Part #	Price
Tie Down Eye Bolt, 1948 .....	#59 .....	<b>\$11.60</b>
Aileron Spacer, 1946-47 .....	108-1001000-8 .....	<b>\$41.39</b>
Lift Strut Lower Fillet Rib, 1946-48 .....	108-1001004 .....	<b>\$48.83</b>
Flap Hinge Fairing, Left, 1946 .....	108-1002006-16 .....	<b>\$148.57</b>
Right, 1946.....	108-1002006-17 .....	<b>\$148.57</b>
Upper Wing Gap Band, Left, 1946-48.....	108-1101002-6 .....	<b>\$63.26</b>
Right.....	108-1101002-7 .....	<b>\$63.26</b>
Lower Wing Gap Band, Left, 1946-48.....	108-1101003-6 .....	<b>\$86.31</b>
Right.....	108-1101003-7 .....	<b>\$86.31</b>
Fuel Tank Strap Reinforcement, 1946-48 .....	108-1101013 .....	<b>\$14.20</b>
Fuel Tank Strap Cover, 1946-48 .....	108-1101014 .....	<b>\$40.65</b>
Front Spar Tip, 1946-48, Left.....	108-1111006-6 .....	<b>\$110.49</b>
Right.....	108-1111006-7 .....	<b>\$110.49</b>
Spar Drag Wire Block, 1946-48, Left .....	108-1111051-6 .....	<b>\$54.68</b>
Right.....	108-1111051-7 .....	<b>\$54.68</b>
Aft Front Spar Bracket, 1946-48, Left		
S/N 1 to 742.....	108-1111056-0A .....	<b>\$212.85</b>
S/N 743 to 3500.....	108-1111056-0B .....	<b>\$203.91</b>
Aft Front Spar Bracket, 1946-48, Left		
S/N 1 to 742.....	108-1111056-1A .....	<b>\$224.84</b>
S/N 743 to 3500.....	108-1111056-1B .....	<b>\$224.84</b>
Forward Front Spar Bracket, 1946-47, Left		
S/N 1 to 742.....	108-1111057-0A .....	<b>\$371.07</b>
S/N 743 to 3500.....	108-1111057-0B .....	<b>\$371.07</b>
Forward Front Spar Bracket, 1946-47, Right		
S/N 1 to 742.....	108-1111057-1A .....	<b>\$371.07</b>
S/N 743 to 3500.....	108-1111057-1B .....	<b>\$371.07</b>
Rear Spar Tip, Right, 1946-47.....	108-1111061-7 .....	<b>\$62.16</b>
Rear Spar Tip, Left, 1946-48 .....	108-1111061-8 .....	<b>\$87.37</b>
Rear Spar Tip, Right, 1948.....	108-1111061-9 .....	<b>\$114.15</b>
Spar Drag Wire Block, 1946-48, Left .....	108-1111063-6 .....	<b>\$70.84</b>
Right.....	108-1111063-7 .....	<b>\$42.66</b>
Aft Rear Spar Bracket, 1946-48, Left		
S/N 1 to 742.....	108-1111064-0A .....	<b>\$371.07</b>
S/N 743 to 3500.....	108-1111064-0B .....	<b>\$371.07</b>
Aft Rear Spar Bracket, 1946-48, Right		
S/N 1 to 742.....	108-1111064-1A .....	<b>\$371.07</b>
S/N 743 to 3500.....	108-1111064-1B .....	<b>\$371.07</b>
Forward Rear Spar Bracket, 1946-48, Left		
S/N 1 to 742.....	108-1111065-0A .....	<b>\$371.07</b>
S/N 743 and up.....	108-1111065-0B .....	<b>\$371.07</b>
Forward Rear Spar Bracket, Right, 1946-48		
S/N 1 to 742.....	108-1111065-1A .....	<b>\$371.07</b>
S/N 743 and up.....	108-1111065-1B .....	<b>\$371.07</b>
Aileron Bellcrank Bracket, 1946-48.....	108-1111069 .....	<b>\$30.49</b>
Spar Drag Wire Block, 1946-48, Left .....	108-1111074-8 .....	<b>\$47.26</b>
Right.....	108-1111074-9 .....	<b>\$47.26</b>

Forward Front Spar Fitting, 1946-48, Left.....	108-1111076-400 .....	<b>\$128.04</b>
Right.....	108-1111076-401 .....	<b>\$128.04</b>
Landing Light Retainer, Left, 1946-48.....	108-1111084-6 .....	<b>\$36.43</b>
Landing Light Lens Retainer, 1946-48 .....	108-1111086 .....	<b>\$29.25</b>
Landing Light Lens Retainer, Left, 1946-48.....	108-1111087 .....	<b>\$24.71</b>
Landing Light Bracket, 1946-48.....	108-1111088 .....	<b>\$55.80</b>
Landing Light Bracket, 1946-48.....	108-1111089 .....	<b>\$55.80</b>
Cabin Ventilator Intake Grille, 1946-48 .....	108-1111130 .....	<b>\$33.52</b>
Forward Rear Spar Fitting, Left or Right, 1948.....	108-1112078-1 .....	<b>\$177.87</b>
Forward Rear Spar Fitting, Left, 1946-47 .....	108-1112078-400 .....	<b>\$85.85</b>
Right.....	108-1112078-401 .....	<b>\$85.85</b>
Aft Rear Spar Fitting, Left, 1946-47.....	108-1112079 .....	<b>\$53.78</b>
Right.....	108-1112079-1 .....	<b>\$70.84</b>
Aft Front Spar Fitting, 1948.....	108-1112150 .....	<b>\$176.89</b>
Aft Rear Spar Fitting, Left or Right, 1948 .....	108-1112151-0 .....	<b>\$181.15</b>
Filler Neck Gasket, 1946-48.....	108-1121109 .....	<b>\$13.97</b>
Fuel Tank Strap, 1946-48.....	108-1121119 .....	<b>\$203.33</b>
Fuel Tank Strap Clip, 1946-48.....	108-1121121 .....	<b>\$15.87</b>
Fuel Tank Vent, 1948 .....	108-1122133-2 .....	<b>\$143.17</b>
Aileron Bellcrank, S/N 1 to 3109, Left .....	108-1141204-0 .....	<b>\$377.41</b>
Right.....	108-1141204-1 .....	<b>\$377.41</b>
Aileron Push Pull Rod, S/N 1 to 3109 .....	108-1141207-0 .....	<b>\$246.84</b>
Aileron Push Pull Rod, S/N 3110 and up.....	108-1141207-1 .....	<b>\$343.10</b>
Wing Flap Control Bellcrank, S/N 1 to 3109 .....	108-1141500 .....	<b>\$287.87</b>
Wing Flap Bellcrank Support, S/N 1 to 3109		
Left.....	108-1141501-0 .....	<b>\$154.97</b>
Right.....	108-1141501-1 .....	<b>\$154.97</b>
Wing Flap Bellcrank Support, S/N 3110 and up		
Left.....	108-1141501-2 .....	<b>\$175.36</b>
Right.....	108-1141501-3 .....	<b>\$156.23</b>
Aileron Bellcrank, S/N 3110 and up, Left.....	108-1142204-0 .....	<b>\$270.36</b>
Right.....	108-1142204-1 .....	<b>\$270.36</b>
Wing Flap Control Bellcrank, S/N 3110 and up.....	108-1142500 .....	<b>\$323.60</b>
Landing Light Deflector, 1946-48 .....	108-1161003 .....	<b>\$26.13</b>
Flap Assembly, 1946-48, Left.....	108-12906 .....	<b>\$3,876.24</b>
Right.....	108-12906-1 .....	<b>\$3,876.24</b>
Aileron Rib, 1946-47, Left .....	108-1711000-6 .....	<b>\$12.78</b>
Right.....	108-1711000-7 .....	<b>\$12.78</b>
Aileron Rib, 1946-47, Left .....	108-1711000-8 .....	<b>\$13.94</b>
Right.....	108-1711000-9 .....	<b>\$13.94</b>
Aileron Rib, 1946-47, Left .....	108-1711000-10 .....	<b>\$21.32</b>
Right.....	108-1711000-11 .....	<b>\$21.32</b>
Aileron Former, 1946-47, Left .....	108-1711000-14 .....	<b>\$50.65</b>
Right.....	108-1711000-15 .....	<b>\$50.65</b>
Aileron Former, 1946-47, Left .....	108-1711000-18 .....	<b>\$99.47</b>
Right.....	108-1711000-19 .....	<b>\$256.59</b>
Aileron Channel, 1946-47 .....	108-1711000-26 .....	<b>\$7.10</b>
Aileron Bracket, 1946-47, Right .....	108-1711000-29 .....	<b>\$11.11</b>
Aileron Tip Trailing Edge Former, 1946-47.....	108-1711005 .....	<b>\$53.47</b>
Aileron Trailing Edge Former, 1946-47, Left .....	108-1711006-0 .....	<b>\$415.82</b>
Right.....	108-1711006-1 .....	<b>\$415.82</b>
Aileron Trim Tab, S/N 2250 to 3500 .....	108-1711014 .....	<b>\$7.10</b>
Aileron Tip Brace Rib, 1946-47, Left .....	108-1711016 .....	<b>\$19.33</b>
Right.....	108-1711016-1 .....	<b>\$53.97</b>
Rear Lift Strut Yoke, 1946-48 .....	108-1911013 .....	<b>\$109.54</b>
Door Friction Catch, 1948.....	108-3000250 .....	<b>\$8.77</b>
Wing Tip Antenna Bracket, 1948 .....	108-3032526 .....	<b>\$11.38</b>
Fuel Tank Strap Bolt, 1946-48 .....	108-8311000 .....	<b>\$42.49</b>

### Ailerons

- Uncovered
- On 108-3 aircraft, these ailerons may be used instead of the 1712020-0 and 1712020-1, if used in pairs

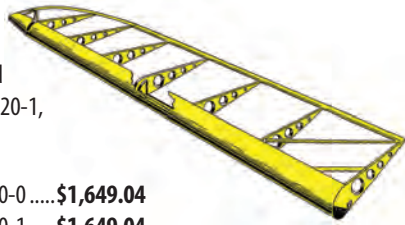

Left ..... 108-1711000-0 ..... **\$1,649.04**  
 Right ..... 108-1711000-1 ..... **\$1,649.04**

### Rod End Bearings

This **threaded** rod end bearing is used on pushrod assemblies manufactured by Univair in 1981 and later.

- Applicability: Stinson flap and aileron pushrod rod end bearing
- Thread: 3/8"-24
- Bore: 3/16 inch
- Type Shank: Male



Threaded Rod End Bearing, Male .....GMM-3M-680 ..... **\$26.50**

This **unthreaded** rod end bearing is used on factory original and replacement parts manufactured prior to 1981.



Unthreaded Rod End Bearing .....REP3H5 ..... **\$85.76**

### Aileron Inspection Hole Frame and Cover



Aileron Inspection Hole  
 Cover ..... 108-1711012 ..... **\$22.32**  
 Frame ..... 108-1711011 ..... **\$11.36**

### Strut Fillets

Upper Lift Strut Fillet

Front, Left ..... 108-1001001-0 ..... **\$111.13**  
 Front, Right ..... 108-1001001-1 ..... **\$111.13**  
 Rear, Left ..... 108-1001002-0 ..... **\$107.89**  
 Rear, Right ..... 108-1001002-1 ..... **\$107.89**



Lower Lift Strut Fillet

Left ..... 108-1001003-0 ..... **\$238.96**  
 Right ..... 108-1001003-1 ..... **\$238.96**

### Leading Edge Slat

- Applicability: All 108 Stinsons

Leading Edge Slat .....108-1811300-2..... **\$639.99**



### Pitot Tube

108-1131002 ..... **\$397.95**



### Lift Struts

- Lifts struts will be shipped via freight only

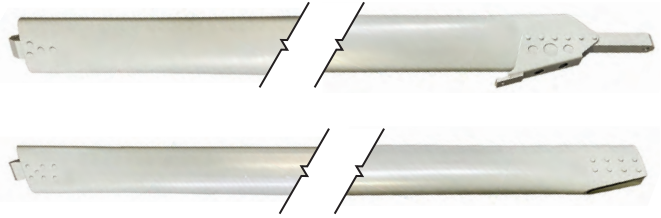

Front Strut ..... 108-1911000 ..... **\$2,012.49**  
 Rear Strut ..... 108-1911010 ..... **\$1,614.68**

### NOTES

---

---

---

---

---

---

---

---

---

---

---

---

---

---

---

---

---

---

---

---

---

---

---

---





## Wing Panel Assemblies, Uncovered

See Figure 1 on page 166

- Wing assemblies do not include flaps, ailerons, pitot tubes, fuel tanks or landing lights
- All products are priced and sold individually unless otherwise noted
- Wing assemblies are shipped via Freight only and will incur crate charges

Fig	Description	Part Number	Price
1946-47	Wing Assembly, Uncovered, Left	108-1111000-1	\$19,978.85
1946-47	Wing Assembly, Uncovered, Right	108-1111001-1	\$19,978.85
1948	Wing Assembly, Uncovered, Left	108-1111000-2	\$19,978.85
1948	Wing Assembly, Uncovered, Right	108-1111001-2	\$19,978.85
1)	Wing Root Rib Assembly, Left	108-1111038-0 <sup>1</sup>	\$557.73
	Wing Root Rib Assembly, Right	108-1111038-1 <sup>1</sup>	\$486.63
	Wing Root Rib Assembly, Left	108-1111038-2 <sup>2</sup>	\$370.45
	Wing Root Rib Assembly, Right	108-1111038-3 <sup>2</sup>	\$956.15
	Wing Root Rib Assembly, Left	108-1111038-4	\$395.08
	Wing Root Rib Assembly, Right	108-1111038-5	\$395.08
2)	Wing Rib, Stations 12.88 through 33.50	108-1111009 <sup>5</sup>	\$148.03
3)	Wing Rib	108-1111010	\$136.09
4)	Wing Rib, Station 170.19, Tip, Left	108-1111032-0	\$243.71
	Right	108-1111032-1	\$217.26
5)	Wing Tip Assembly, Left	108-1111050-0	\$1,901.04
	Right	108-1111050-1	\$2,644.68
6)	Trailing Edge, Stations 156.00 through 170.19		
	Left	108-1111047-0	\$170.15
	Right	108-1111047-1	\$158.20
7)	Outboard Trailing Edge, Left	108-1111046-0	\$527.56
	Right	108-1111046-1	\$433.97
8)	Inboard Trailing Edge, Left	108-1111045-0	\$433.97
	Right	108-1111045-1	\$433.97
	Left	108-1111045-2	\$433.97
	Right	108-1111045-3	\$433.97
9)	Leading Edge Skin, Root Rib to Station 104.31		
	Left	108-1111043-6	\$636.46
	Left	108-1111043-10	\$452.02
10)	Leading Edge Skin, Stations 104.31 through 143.81		
	Left	108-1111040-6	\$89.71
	Right	108-1111040-7	\$104.16
11)	Leading Edge Skin, Outboard, Left	108-1111041-10	\$501.75
	Right	108-1111041-11	\$473.35
12)	Trailing Edge Hanger, Stations 116.875 and 155.875		
	Left	108-1111021-0	\$337.50
	Right	108-1111021-1	\$337.50
13)	Wing Trailing Edge Former	108-1111013	\$37.57
14)	Wing Rib, Station 94.00	108-1111123	\$110.58
15)	Trailing Edge Former, Station 113.50	108-1111108	\$41.63
16)	Trailing Edge Hanger, Station 77.875, Left	108-1111028	\$289.61
	Right	108-1111028	\$289.61
17)	Trailing Edge Former	108-1111008-6	\$39.48
18)	Trailing Edge Hanger, Station 46.00, Left	108-1111011-400	\$228.28
	Right	108-1111011-401	\$228.28
	Left	108-1112149-1	\$402.75
	Right	108-1112149-0	\$178.96
19)	Former, Wing Trailing Edge, Station 33.50	108-1111107	\$33.89

20)	Trailing Edge Former	108-1111029-6	\$37.57
21)	Trailing Edge Hanger, Station 1.625, Left	108-1111012-0 <sup>3</sup>	\$228.28
	Right	108-1111012-1	\$228.28
	Left	108-1111012-2 <sup>6</sup>	\$228.28
22)	Leading Edge Former, Stations 12.88 through 35.50 and 104.31	108-1111020-6	\$40.58
23)	Leading Edge Former, Station 46.00	108-1111110	\$116.62
24)	Leading Edge Former, Stations 43.875 through 94.00 and 143.81	108-1111016	\$76.86
25)	Former Assembly, Wing Leading Edge	108-1111072	\$155.64
26)	Leading Edge Former, Stations 104.31 through 130.56	108-1111017	\$70.23
27)	Leading Edge Former	108-1111073	\$189.46
28)	Leading Edge Former, Station 156.00	108-1111015	\$46.35
29)	Front Spar Assembly, Left	108-1111002-2	\$1,600.80
	Right	108-1111002-3	\$1,600.80
	Left	108-1112146	\$2,930.42
	Right	108-1112146-1	\$2,930.42
30)	Rear Spar Assembly, Left	108-1111060-2 <sup>4</sup>	\$958.02
	Left	108-1111060-4 <sup>7</sup>	\$958.02
	Right	108-1111060-5 <sup>7</sup>	\$958.02
	Left	108-1112147-0	\$2,825.77
	Right	108-1112147-7	\$1,163.53
31)	Wing Brace Tube	108-1111109-6	\$64.47
	Wing Brace Tube	108-1111109-8	\$64.47
32)	Wing Compression Tube Assembly	108-1111025-1	\$319.97
	Wing Compression Tube Assembly	108-1111025-1	\$319.97
33)	Drag Wire Spar Block, Station 87.188, Left	108-1111049-6	\$46.94
	Right	108-1111049-7	\$46.94
34)	Landing Light Support	108-1111083	\$27.04
35)	Wing Brace, Stations 0.00 and 46.00 Rib	108-1111106	\$15.09
36)	Flap and Aileron Hinge (includes item 38)	108-1111034	\$156.21
37)	Drag Wire, 41.50" Long	108-1111054-6	\$43.82
38)	Bearing	CS3906	\$38.74
39)	Wing Rib, Station 155.875	108-1111124	\$122.11
40)	Drag Wire, 51.00" Long	108-1111054-7	\$96.13
41)	Cabin Ventilator Air Intake Bulkhead, Left	108-1111106	\$15.09
	Right	108-1111107	\$33.89
42)	Drag Wire, 41.50" Long	108-1111054-10	\$46.94
43)	Spar Tip Rib	108-1111122	\$85.08
44)	Inboard Leading Edge Skin, Left	108-1111041-8	\$551.05
	Right	108-1111041-9	\$551.05
45)	Felt Seal (2 required per hanger)	108-8001001	\$2.71

<sup>1</sup> For airplanes serial 108-1 through 108-2572

<sup>2</sup> For airplanes serial 108-2573 through 108-3500

<sup>3</sup> For airplanes serial 108-1 through 108-2509

<sup>4</sup> For airplanes serial 108-1 through 108-3109

<sup>5</sup> Six each used per plane on serial 108-1 through 108-3500 and eight per plane on serial 108-3501 and up

<sup>6</sup> For airplanes serial 108-2510 and up

<sup>7</sup> For airplanes serial 108-3110 through 108-3500

Visit our website to browse our full line of Stinson parts and supplies.

## Figure 1 • Wing Panel Assembly

Parts list begins on page 165.

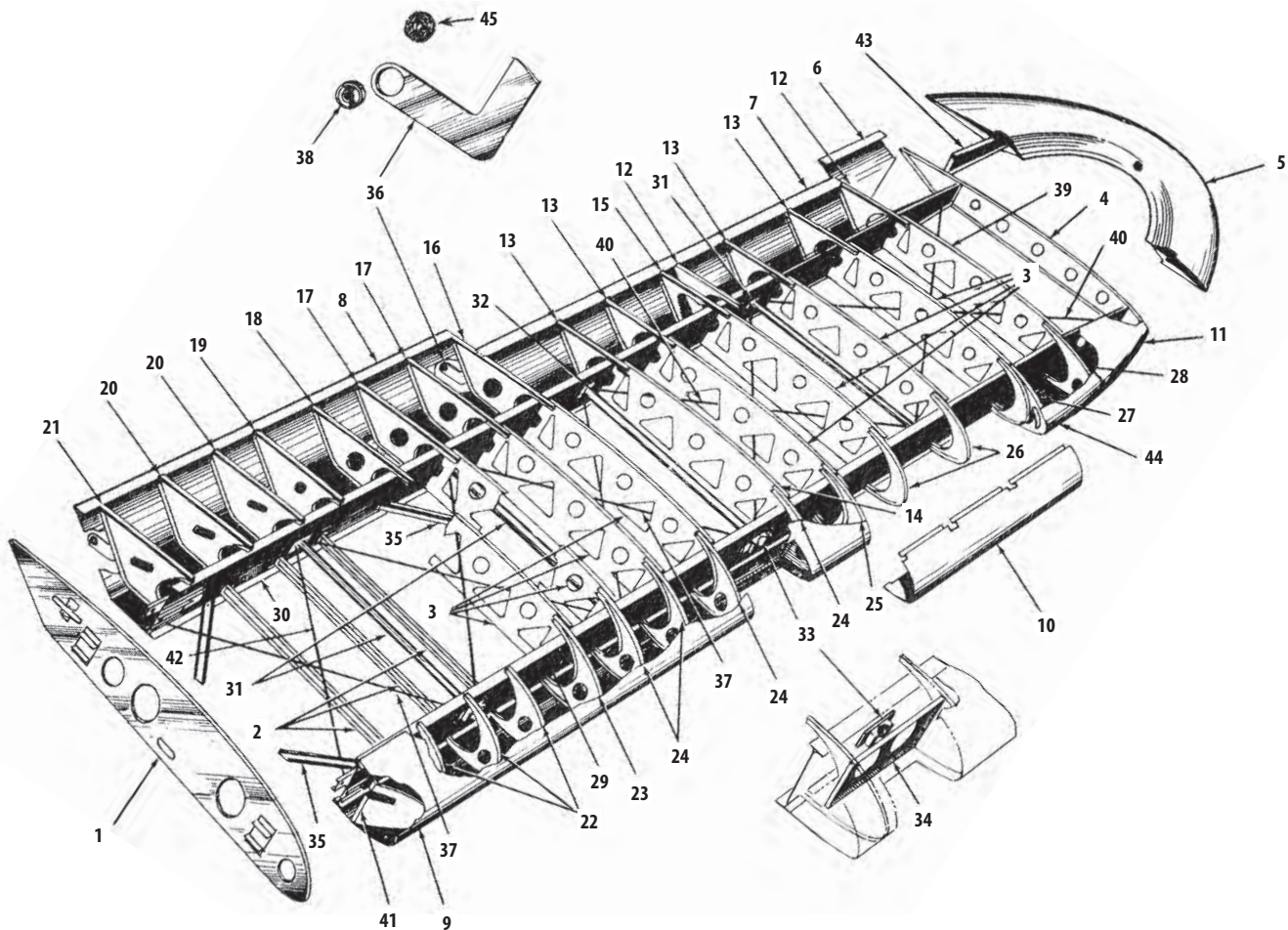

## Engine Conversion Kits

Univair holds STC approval SA2718NM for the O-360 series Lycoming engine (180hp) for the 108, 108-1, 108-2, and 108-3 Stinsons. Univair also holds the STC for the IO-360 series engine (200hp) for the 108-3. These engines offer increased performance, a 2,000 hour TBO for the O-360, an 1,800 hour TBO for the IO-360. Besides an improvement in TBO over the original Franklin engines, these engines offer greater serviceability. They run on the more readily available 100LL avgas and are two of the most popular engines in use in general aviation today. Univair can supply for these conversions: engine mounts, baffles, exhaust systems, propellers and various detail parts, including rudder bungee and ½ inch fuel lines when required. Univair can supply all necessary ½ inch fuel line components except the fuel valve.

### Performance Information

Univair publishes no performance data for either of these engine conversions. The supplemental flight manuals for these installations do state that these conversions will deliver the same or better performance than what the aircraft was originally certified for. Neither of these engine conversions allow for an increase in gross weight.

Customers who have installed wither the 180hp or 200hp engine conversions have noted significantly better climb and short field performance especially with a climb propeller in the case of the 180hp installation. The same is true with the Hartzell constant speed propeller and 200hp installation on the 108-3. Customers have reported modest increases in airspeed with both installations. A greater increase in speed has been reported on the 108-3 with the 200hp installation compared to the 180hp installation. The original maximum structural cruise speed limit remains the same after the engine conversions.

More details on Stinson engine conversion kits can be found on our website

UNIVAIR AIRCRAFT CORPORATION

2500 Himalaya Road, Aurora, Colorado 80011

November 12, 1963

## STINSON SERVICE INFORMATION LETTER NO. 74A

Installation of Franklin 6A4-165-B3 165hp Engine and Rudder Bungee on Stinson 108 and 108-1 airplanes.

The following information is applicable to such a change:

1. The original aircraft frame and engine mount for Models 108, 108-1, 108-2 and 108-3 are structurally satisfactory for this installation.
2. Models 108 and 108-1 will require installation of revised fuel system as shown in Stinson Drawing 108-6222100 "G". This includes increasing fuel line and fittings to ½ inch.
3. The original center of gravity range, gross weight and airspeed limits are retained.
4. Model 108 and 108-1 will require installation of rudder bungee in accordance with Drawing 108-3042450.
5. Cowling and baffles as shown in Drawing 108-6021401 "L" and 108-6221201 "H" are required for the 165hp engine.
6. Propellers as listed in Specifications A-767 as eligible for the Model 108-2 are satisfactory for use on the modified aircraft.
7. Installation of this engine may be made on the basis of this letter by the local A & P mechanic with the usual FAA 337 form. The Flight Manual Revision, supplied with kit, should be placed in the aircraft.
8. Re-mark tachometer to red line at 2800 RPM, cylinder heat to 530°F for spark plug type thermocouple, 445°F for bayonet type thermocouple.
9. This installation is eligible on the land plane, sea plane, and ski plane version.

*Robert M. Williams*  
STINSON SERVICE DEPARTMENT

FAA APPROVED

DATE *Nov 18, 1963*

## 165 Franklin vs. 180/200 Lycoming

165 Franklin		
% Power	Output	Fuel Consumption
82%	135hp	10.5 gph
75%	123hp	9.7 gph
71%	117hp	9.3 gph
65%	107hp	8.6 gph

180 Lycoming			200 Lycoming	
% Power	Output	Fuel Consumption	Output	Fuel Consumption
75%	135hp	10.5 gph	150hp	10.4 gph
68%	122hp	9.5 gph	137hp	9.4 gph
65%	117hp	9.0 gph	130hp	9.1 gph
61%	110hp	8.4 gph	123hp	8.5 gph
55%	99hp	7.4 gph	110hp	7.5 gph

### Lycoming O-360 Series • 180hp

Our STC covers the installation of the O-360 series\* 180hp Lycoming engine with fixed-pitch Sensenich propeller for the entire 108 series of Stinsons. The 3/8 inch fuel lines in the 108 and 108-1 will have to be replaced with 1/2 inch fuel lines. This will require a modification of the fittings on the fuel tanks. Univair can supply all the necessary 1/2 inch fuel line components with the exception of the fuel valve. Also, the 108 and 108-1 will require the Rudder Bungee Kit if not already installed. Neither the fuel lines or Rudder Bungee Kit are included in the Minimum or Detail kits listed below; they must be purchased separately from Univair. The 108-2 and 108-3 already have 1/2 inch fuel lines. The 108-2 will also have the Rudder Bungee Kit already installed. The 108-3 does not require the Rudder Bungee Kit as it has a rudder with a pilot adjustable trim tab.

This engine conversion will allow the use of the existing cowling requiring some modifications to the nose and lower cowl.

Below are lists of major items that we require as a minimum of purchased parts from Univair. These Minimum Conversion Kits will be sold only as a complete package. Other "detail" items are needed for the installation. However, they may be purchased individually from Univair or from other vendors. These include items such as controls, ducting, hoses, etc.

Note: In developing this STC installation, Univair used the narrow (standard) deck engine. Installations using the later wide deck engines may require minor modifications to the baffling.

\* O-360 engines approved for this STC are O-360-A1A, -A1D, -A1F, -A1F6, -A1F6D, -A2A, -A2D, -A1AD, -A2E, -A2F, -A3A, -A3AD, -A4AD, -A4M, and -A5AD

### Kits for O-360 180hp Conversion

Minimum Kit (See List Below) .....	180MK.....	<b>\$17,613.49</b>
Detail Kit (See List Next Page).....	180DK.....	<b>\$6,797.25</b>
Sensenich Propeller 76EM8 Series.....		<b>CALL</b>
Rudder Bungee Kit* .....	108-3042450.....	<b>\$3,050.84</b>

\* Required for 108 and 108-1

Customers with wide deck engines who wish to convert from a generator to an alternator can purchase the 015-01236WD Alcor Alternator Kit from InterAv (phone 210-344-2785). The adjustment bracket supplied in this kit is not applicable; however that bracket (108-U9001062) can be supplied at no additional charge upon request.

### 180MK Minimum Kit

**\$17,613.49**

This kit includes the parts listed below. Engine not included.

Description	Quantity	Part #
Engine Mount .....	1 .....	108-U-9001023
Baffle Set .....	1 .....	O-360
Oil Cooler .....	2 .....	8000075
Oil Cooler Take Off .....	1 .....	108-U-9001024
Spinner Assembly .....	1 .....	U14422-B
Carburetor Air Box.....	1 .....	108-U9001059
Exhaust Manifold .....	1 .....	108-U9001064
Muffler Assembly.....	2 .....	108-U9001015-3A
Shroud .....	1 .....	108-622209-20
Shroud .....	1 .....	108-6221210-20
Shroud Clip.....	2 .....	108-6221704
Flame Tube.....	2 .....	108-U9001061
Bracket.....	1 .....	108-U9001062
Muffler Hanger .....	2 .....	108-6221710
Leather Gasket .....	1 .....	11950-004
Oil Pressure Tube.....	1 .....	108-U9001002-2
Fuel Line .....	1 .....	108-6222101-10
Oil Cooler Tube .....	1 .....	108-U9001002-56
Oil Cooler Tube .....	1 .....	108-U9001002-57
Oil Cooler Tube .....	1 .....	108-U9001002-58
Eyebrow .....	1 .....	108-6022421
Alternator Adjustment Arm .....	1 .....	108-U9001051
Alternator Belt .....	1 .....	3L320
STC Paperwork and Blueprints .....	1 .....	SA2718NM

### 180DK Detail Kit

**\$6,797.25**

This kit includes the items listed below, or they can be purchased separately.

Description	Quantity	Part #	Price
Oil Pressure Line.....	1 .....	108-U-9001008-2 .....	<b>\$96.17</b>
Aeroduct .....	2 ft .....	CAT16 .....	<b>\$15.75/ft</b>
Hose Clamps .....	2 .....	20060S .....	<b>\$7.07</b>
Tachometer Cable .....	1 .....	TACH-37 .....	<b>\$161.70</b>
Aeroduct .....	1 ft .....	SCAT4 .....	<b>\$10.40/ft</b>
Aeroduct .....	2 ft .....	SCEET8 .....	<b>\$23.21/ft</b>
Aeroduct .....	8 ft .....	SCAT8 .....	<b>\$20.16/ft</b>
3/4 inch Hose .....	3 ft .....	MIL6000-12 .....	<b>\$13.49/ft</b>
Elbow.....	1 .....	49X8 .....	<b>\$12.03</b>
Button Lock Control.....	1 .....	A700-10-0600 .....	<b>\$115.99</b>

Throttle Control.....	1.....	A750-10-0526.....	<b>\$182.45</b>
Mixture Control.....	1.....	A750-20-0480.....	<b>\$113.21</b>
Lord Mount.....	4.....	J7402-24.....	<b>\$209.49</b>
Swivel.....	1.....	U70371-003.....	<b>\$27.73</b>
Rod End.....	2.....	89307-000.....	<b>\$69.01</b>
Air Filter Assembly.....	1.....	BA-4106.....	<b>\$77.30</b>
Tail Pipe.....	2.....	108-U-9001011.....	<b>\$1,085.88</b>
Baffle Air Scoop.....	1.....	108-U-9001055.....	<b>\$479.53</b>
Muffler Clamp.....	2.....	108-U-9001058.....	<b>\$83.14</b>
Hanger.....	1.....	108-U-9001053-00.....	<b>\$54.34</b>
Hanger.....	1.....	108-U-9001053-01.....	<b>\$54.34</b>
Cowl Reinforcement Ring.....	1.....	108-U-9001050.....	<b>\$44.36</b>
Bushing.....	1.....	108-U-9001065.....	<b>\$9.07</b>
60-0-60 Ammeter.....	1.....	82311.....	<b>\$62.98</b>
Fitting.....	1.....	AN816-8D.....	<b>\$8.72</b>
Fitting (AN822-8D).....	2.....	MS20822-8D.....	<b>\$89.71</b>
Fitting (AN823-8D).....	3.....	MS20823-8D.....	<b>\$28.20</b>

## Lycoming IO-360 Series • 200hp

### Applicable on Stinson 108-3 Only

Univair holds STC approval SA1552NM for the installation of the IO-360\* 200hp engine conversion with Hartzell constant speed propeller on the Stinson 108-3. This conversion is simple and a direct replacement of the Franklin 165hp engine and related accessories with a more modern, fuel efficient and more powerful Lycoming IO-360 series engine package.

This conversion retains the existing lower cowling; however, it must be modified. A new deeper nose cowl and longer side cowling are required. A new fuel boost pump is required. Because of the installation of the constant speed propeller and related accessories, the battery box must be relocated behind the baggage compartment.

There are standard and wide deck versions of the Lycoming IO-360. To insure that we provide the proper parts for your installation, we need to know which version you have. Information on how to determine this is on page 166.

Below is a list of major items required for this installation as contained in the Minimum Conversion Kit. This kit will only be sold only as a complete package. Other "detail" items needed for the conversion such as controls, ducting, hoses, etc., can be purchased individually.

Note: In developing this STC installation, Univair used the narrow (standard) deck engine. Installations using the later wide deck engines may require minor modifications to the baffling.

\* IO-360 engines approved for this STC are IO-360-A1A, -A1B, -A1B6, and -A1C

## Kits for IO-360 200hp Conversion

### Conversion Kit

200hp Minimum Kit (See List Below) ..... 200MK ..... **\$16,221.37**

### All Metal Bottom Cowl for 200hp Conversion

Bottom Cowl.....108-U-9001040..... **\$3,007.81**

### Hartzell Propeller and Accessories

Hartzell Propeller (HC-C2YK-1BF/F7666A-Z)..... 81-C2K00040..... **CALL**

Governor.....H1..... **CALL**

Hartzell Spinner Assembly..... 835-44..... **CALL**

Customers with wide deck engines who wish to convert from a generator to an alternator can purchase the 015-01236WD Alcor Alternator Kit from InterAv (phone: 210-344-2785). The adjustment bracket supplied in this kit is not applicable; however that bracket is supplied in the Minimum Conversion Kit at no additional charge.

## 200MK Minimum Kit

**\$16,221.37**

This kit includes the parts listed below. Engine not included with kit.

Description	Quantity	Part #
Engine Mount.....	1.....	108-U-9001023
Baffle Set.....	1.....	108-U-9001020
Oil Cooler.....	2.....	8000075
Oil Cooler Take Off.....	1.....	108-U-9001024
Side Cowl Assembly.....	1.....	108-U-9001032
Nose Cowl.....	1.....	108-U-9001033
Bottom Cowl Modification Kit.....	1.....	108-U-9001040KIT
Muffler Assembly, Left.....	1.....	108-U-9001015-3A
Muffler Assembly, Right.....	1.....	108-U-9001015-4A
Shroud.....	1.....	108-6222209-20
Exhaust Manifold.....	1.....	108-U-9001034
Shroud Clip.....	2.....	108-6221704
Flame Tube.....	2.....	108-U-9001010
Tailpipe Hanger Kit.....	1.....	108-U-9001016KIT
Alternate Air Box Assembly.....	1.....	108-U-9001019
Auxiliary Fuel Pump.....	1.....	1500-00-44
Baffle Bracket Kit.....	1.....	108-U-9001021KIT
Alternator Drive Belt.....	1.....	8368
STC Paperwork and Blueprints.....	1.....	SA1552NM

## Detail Parts for 200MK Installation

Parts listed below must be purchased separately.

Description	QTY	Part #	Price
Tailpipe, Left.....	1.....	108-U-9001013.....	<b>\$408.73</b>
Tailpipe, Right.....	1.....	108-U-9001014.....	<b>\$408.73</b>
Oil Cooler Flange Fitting.....	1.....	108-U-9001024.....	<b>\$183.36</b>
Auxiliary Fuel Pump Bracket.....	1.....	108-U-9001003.....	<b>\$107.97</b>
Governor Control.....	1.....	A750-10-0290.....	<b>\$105.98</b>
Throttle Control.....	1.....	A750-10-0526.....	<b>\$182.45</b>
Mixture Control.....	1.....	A750-20-0600.....	<b>\$117.94</b>
Alternate Air Control (032-22).....	1.....	—.....	—
Throttle Bracket.....	1.....	108-U-9001004.....	<b>\$59.76</b>
Tachometer Cable.....	1.....	TACH-37.....	<b>\$161.70</b>
Ignition Switch for Non-Impulse Coupled Mags.....	1.....	10-357200-1.....	<b>\$661.42</b>
Battery Box Relocation Kit.....	1.....	U-108-3062020.....	<b>\$776.38</b>
60-0-60 Ammeter.....	1.....	82311.....	<b>\$62.98</b>
Manifold Pressure/Fuel Flow Gauge.....	1.....	—.....	—
Lord Mounts.....	4.....	J7402-24.....	<b>\$209.49</b>
Electrical Wiring, Complete Set.....	1.....	108-U-9001007KIT.....	<b>\$461.96</b>
Engine Hose Kit.....	1.....	HOSE-KIT.....	<b>\$1,371.34</b>
Air Filter Assembly.....	1.....	BA-5110.....	<b>CALL</b>
Ignition Vibrator Starter.....	1.....	10-176487-121.....	<b>\$651.00</b>