



VSP - 118

DATED: April 19, 1999 (S/M)

VENDOR SERVICE PUBLICATION

TO: All Piper Domestic and International Distributors, Authorized Piper Service Centers and publication subscribers.

SUBJECT: Distribution of: **TEXTRON LYCOMING SERVICE INSTRUCTION NO. 1267C, "PISTON PIN PLUG USAGE"**.

MODELS AFFECTED:

All Textron Lycoming Piston Engines
with 5 1/8 inch Cylinder Bores

SERIAL NUMBERS AFFECTED:

All Textron Lycoming Piston Engines
with 5 1/8 inch Cylinder Bores

Note:

A guide to the "Model and Serial Number Affected" is listed on the next page. This should be used as a guide to determine applicability, however, if your serial number or model is not listed here, and you have an engine with 5 1/8 inch cylinder bore, consult with Textron Lycoming using the model and serial number of the engine.

COMPLIANCE TIME: In accordance with the attached TEXTRON LYCOMING Service Instruction SI 1267C, "Piston Pin Plug Usage". *Check the attached publication for compliance time.*

PURPOSE: To provide distribution of TEXTRON LYCOMING Service Instruction SI 1267C , "Piston Pin Plug Usage".

ATA: 7232

Effectivity Reference Guide

MODELS AFFECTED:**SERIAL NUMBERS AFFECTED:**

PA-18/18-150 Super Cub	18-1 through 18-9004
PA-18-150 Super Cub	18- 7309016 through 18-8309025
PA-20 Pacer	1809001 through 1809113
PA-22-125/135 Tripacer	20-1 through 20-1121
PA-22-108 Colt	22-1 through 22-2424
PA-23 Apache	22-8000 through 22-9848
PA-23 235 Aztec	23-1 through 23-2046
PA-23-250 Aztec	27-505 through 27-622
	27-1 through 27-4866
	27-7304917 through 27-8154030
PA-24-180/250 Comanche	24-1 through 24-3687
PA-24-260 Comanche	24-3642, 24-4000 through 24-5028
PA-24-400 Comanche	26-2 through 26-148
PA-28-140 Cherokee	28-20000 through 28-7725290
PA-28-150/160/180 Cherokee	28-1 through 28-7505259 & 28-E13
PA-28-151 Warrior	28-7415001 through 28-7715314
PA-28-161 Warrior II	28-7716002 through 28-8616057
	2816001 through 2816109
PA-28-161 Warrior III	2816110 through 2816119,
	2842001 and up
PA-28-161 Cadet	2841001 through 2841365
PA-28-181 Archer II	28-7690001 through 28-8690056
	2890001 through 2890205
PA-28-181 Archer III	2890206 through 2890231
	2843001 and up
PA-28-235 Cherokee	28-10001 through 28-7710089 & 28-E11
PA-28-236 Dakota	28-7911001 through 28-8611008
	2811001 through 2811050
PA-28R-180 Arrow	28R-30001 through 28R-7130013
PA-28R-200 Arrow/Arrow II	28R-35001 through 28R-7635545
PA-28R-201 Arrow III	28R-7737001 through 28R-7837319
PA-28R-201 Arrow	2837001 through 2837061
	2844001 and up
PA-28RT-201 Arrow IV	28R-7918001 through 28R-8218026
PA-30-Twin Comanche	30-1 through 30-2000
PA-31/300/325 Navajo/Navajo CR	31-2 through 31-861
	31-7300901 through 31-8312019
PA-31-350 Chieftain	31-5001 through 31-5004
	31-7305005 through 31-8452021
PA-31-350 T1020	31-8253001 through 31-8553002
PA-32-260 Cherokee Six	32-1 through 32-7800008
PA-32-300 Cherokee Six	32-40000 through 32-7940290
PA-32-301 Saratoga	32-8006001 through 32-8606023
	3206001 through 3206088
PA-32RT-300T Turbo Lance II	32R-7787001 through 32R-7987126
PA-32R-300 Lance	32R-7680001 through 32R-7880068
PA-32RT-300 Lance II	32R-7885001 through 32R-7985105
PA-32R-301 Saratoga SP	32R-8013001 through 32R-8613006
	3213001 through 3213041
PA-32R-301 Saratoga II HP	3213029, 3213042 through 3213103
	3246001 and up
PA-32R-301T Turbo Saratoga SP	32R-8029001 through 32R-8629006
	3229001 through 3229003
PA-32R-301T Saratoga II TC	3257001 and up
PA-34-200 Seneca	34-7250001 through 34-7450220
PA-38-112 Tomahawk	38-78A0002 through 38-82A0124
PA-39-Twin Comanche	39-1 through 39-155
PA-44-180 Seminole	44-7995001 through 44-8195026, 4495001
	through 4495013, 4496001 through 4496020,
PA-44-180T Seminole	44-8107001 through 44-8207020
PA-46-350P Malibu Mirage	4622001 through 4622200, 4636001 and up

652 Oliver Street
Williamsport, PA 17701 U.S.A.
570/323-6181

SERVICE INSTRUCTION

DATE: February 26, 1999

Service Instruction No. 1267C
(Supersedes Service Instruction No. 1267B)
Engineering Aspects are
FAA Approved

SUBJECT: Piston Pin Plug Usage

MODELS AFFECTED: All Textron Lycoming engines with 5-1/8 inch cylinder bore: O-320; IO-320; O-340, O, IO, HO, LO, LIO, AIO, HIO, TIO, VO and IVO-360; GO, VO and TVO-435; GO, GSO, IGSO-480; O, IO, VO, TIO, TVO, TIVO and IGSO-540; TIO and TIGO-541; IO-720.

TIME OF COMPLIANCE: Any time piston pin plugs are replaced.

There are three different piston pin plugs currently used in the above mentioned models of Textron Lycoming aircraft engines. The various plugs fit interchangeably; however, both plugs in a cylinder must be of the same part number. To preclude the possibility of mixing two different plugs in a cylinder and to simplify plug replacement, at the next piston pin plug replacement, plug P/N LW-11775 should be replaced with P/N 72198. In a complete engine piston pin plug replacement, all plugs should be replaced with P/N 72198. See the illustrations for allowable replacements.

NOTE

Although piston pin P/N LW-14077* was designed to accommodate the P/N LW-11775 plug, P/N 60828 and P/N 72198 plugs may be used with P/N LW-14077 pins. Follow the replacement applications listed below.

Piston pin plug replacement is mandatory during engine overhaul and care should be exercised to be sure the clearance between the plug and piston is not excessive; normal fit is .0002L/.0015L, service maximum .0025L.

CAUTION

Both pin plugs in a cylinder must be of the same part numbers and must be replaced in accordance with the illustrated applications. Coat thrust face of plugs with Texaco Tuban 140 or other pre-lubricant before assembly. See latest edition of Service Instruction No. 1059 for approved lubricants.

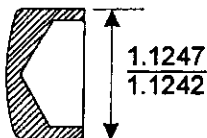

P/N 60828 ALUMINUM PISTON PIN PLUG

In individual cylinders, replace both with P/N 60828 Piston Pin Plugs. In complete engine, replace all with P/N 72198.

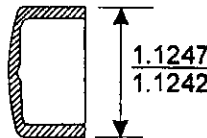

P/N 72198 ALUMINUM BRONZE PISTON PIN PLUG

Replace both plugs in cylinder with P/N 72198 Piston Pin Plug.

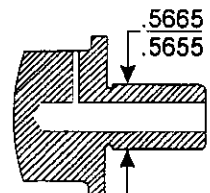

P/N LW-11775 ALUMINUM PISTON PIN PLUG

Remove from service. Replace both pin plugs in cylinder with Piston Pin Plug P/N 72198.

Chart Showing Section Thru Piston Pin Plugs

NOTE

For O-320-E2A, when piston pin P/N LW-14077 is installed, a logbook entry is required.

* - Piston pins P/N's 69650, LW-12383, LW-13444 and LW-13446 are all superseded by piston pins P/N LW-14077 and LW-14078; see latest edition of Service Instruction No. 1340 for parts information.

NOTE: Revision "C" removes P/N LW-11775 piston pin plug from service.